

FleetFit Vehicle Push-In Fittings



FleetFit ShapesFIT-4-2
FleetFit SpecificationsFIT-4-3
FleetFit DimensionsFIT-4-5

- **Simple tube connection and disconnection - no tools required**
- **Fewer component parts - Internally machined form in body to secure collet reduces number of potential leak paths**
- **Corrosion resistant**
- **Easy identification - All collets marked with tube size**
- **Total fittings system solution**
- **Reduced assembly & maintenance times provide time/labor savings**
- **Greater reliability and reduced testing**
- **Ease of tube insertion in areas of restricted access**



Technical Data

Operating Medium:

Compressed air

Maximum Working Pressure:

0 to 150 psi (0 to 10 bar)

Working Temperature:

-40°F to 220°F (-40°C to 100°C)

Materials:

Body (Straights), Tube support, Collet - Brass BS 2874 CZ 121
 Body (Elbows, Tees) - Brass BS 2874 CZ 122
 'O' Ring - Buna N (Low Nitrile).
 Thread Sealant - Precoat 5

Tubing:

Tube should be to SAE J844 (Imperial)
 or DIN 74324 (Metric)

Standards & Legislation:

Fittings and Tubing Comply to Department Of Transport
 Federal Motor Vehicle Safety Standard, (DOT FMVSS 106)
 (Mandatory requirements for Inch tube fittings in U.S.A.)
 Society for Automotive Engineers (SAE) J1131 (Inch tube and
 fittings) and meet DIN 74324 and German TÜV requirements
 (Metric Tube and Fittings)

Applications:

As a connector on all air brake systems at locations other than
 between chassis frame and axle or between towed and towing
 vehicle.

Also as a connector on all air operated systems as applicable
 to suspension, steering, engine, transmission and auxiliary
 mechanisms.

Swivel Fittings:

The swivel feature should be used for positioning purposes
 only and should not be used as a rotating joint.

Ordering Information

To order, quote the appropriate product
 number from the tables on the following pages.

Options

Tube Sizes - Imperial and Metric

For metric tube sizes and tube sizes below 1/4"
 and 6mm please consult our technical services
 department.

Standard Thread sizes - NPT, Metric, BSP
 Non-standard thread sizes are also included
 (e.g. UNF)

Note: Part numbers in **bold** are generally
 available from stock. For specialised shapes
 and thread forms contact Norgren Detroit's
 Technical Support.

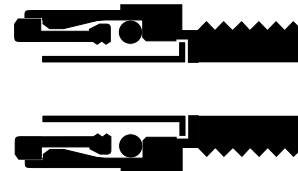



Typical Layout & Dimensions

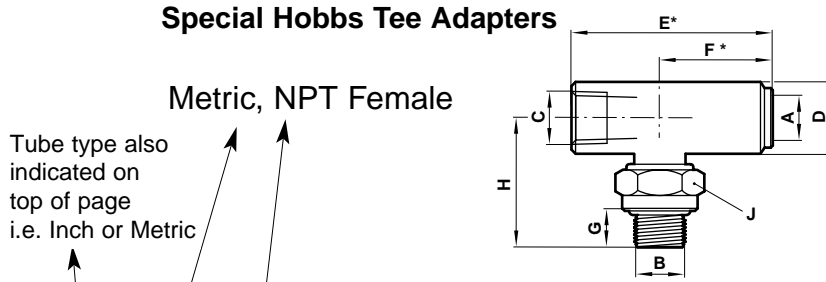

* Similar dimensions given in individual tables refer to the collet being in the 'IN' position.

A Tube O.D.	B Thread	C NPT Female	Product Number	ØD	E	F	G	H	J A/F
3/8"	M16 x 1.5	1/4"	95 4621 03	0.75 (19.0)	2.07 (52.5)	1.12 (28.5)	0.41 (10.5)	1.32 (33.5)	1.06 (27)
3/8"	M22 x 1.5	1/4"	95 4621 02	0.87 (22.0)	2.20 (56.0)	3.46 (32.0)	0.51 (13.0)	1.70 (43.0)	1.06 (27)
1/2"	M22 x 1.5	1/4"	95 4621 01	0.87 (22.0)	2.36 (60.0)	1.42 (36.0)	0.51 (13.0)	1.70 (43.0)	1.06 (27)

Installation

Tube Connection / Disconnection

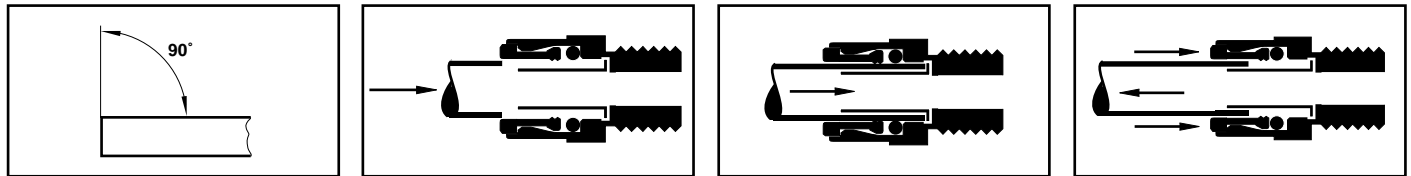

1. Ensure that the end of the tube is cut square and is free from burrs.
2. Push the tube through the collet into the fitting.
3. Continue pushing the tube through the 'O' ring until it bottoms on the tube stop. Then pull back on the tube to reinforce the collet teeth gripping action.
4. To disconnect - First ensure there is no air present. Push the tube into the fitting until it bottoms on the tube stop. Then hold down the collet and withdraw the tube.

Component Functions

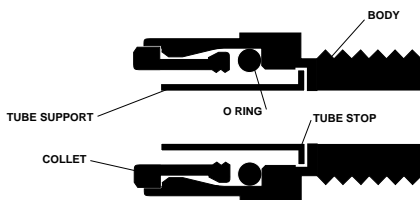

- Body** - The body has an internally machined form to secure the collet(s), "O" ring(s) and Tube support(s). It also has internal & externally machined thread form(s) for connection to ports where applicable.
- Collet** - The purpose of the collet is to grip the tube and ensure it is retained by the fitting at all times.
- "O" Ring** - The "O" ring is to ensure adequate interference between the tube & fitting body therefore providing a pneumatic seal at all times.
- Tube Support** - The tube support prevents the tube collapsing during extreme tensile loading conditions. Such conditions are only encountered during performance testing and far exceed those experienced during normal use.



FleetFit Vehicle Shapes



Male Connectors
NPT and Metric p. FIT-4-5
BSP taper p. FIT-4-6
UNF / SAE 45° Flare
p. FIT 4-6.



Female Connectors
NPT p. FIT-4-6
UNF p. FIT-4-7



Straight Unions
Inch p. FIT-4-7



Straight Bulkhead Unions
Metric p. FIT-4-7



Female Bulkhead
Connectors
NPT Female, UNF
p. FIT-4-7



Male Bulkhead
Connectors
Metric/metric,
BSPT/Metric p. FIT-4-8

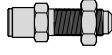

Straight Bulkhead Adapters
UNF / SAE 45° Flare
p. FIT-4-8



Plug (thermoplastic)
p. FIT-4-9



Male Elbows
NPT p. FIT-4-9
BSP Taper p. FIT-4-10.



Male Hobbs Elbows
Metric p. FIT-4-10



Male Swivel Elbow
NPT p. FIT-4-11

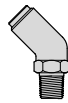

45° Male Elbow
NPT p. FIT-4-11



45° Male Hobbs Elbow
Metric and NPT
p. FIT-4-11



90° and 45° Female Elbow
NPT
p. FIT-4-12



Union Elbows
p. FIT-4-12



Union Bulkhead Elbows
Metric P. FIT-4-12
NPT Female, UNF
p. FIT-4-13

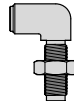

Bulkhead Elbow Adapters
UNF/SAE 45° Flare
p. FIT-4-13

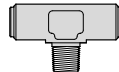

Male Branch Tees
NPT p. FIT-4-13
BSP Taper p. FIT-4-14

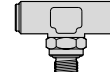

Hobbs Tee Adapters
Metric p. FIT-4-14

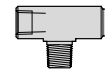

Special Tee Adapters
NPT, NPT Female
p. FIT-4-14

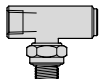

Universal Hobbs Tee
Adapters
Metric, NPT Female
p. FIT-4-15

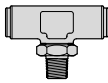

Male Swivel Branch Tees
NPT p. FIT-4-15

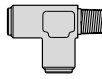

Male Run Tees
NPT p. FIT-4-16
NPT, NPT Female
p. FIT-4-17
metric p. FIT-4-15

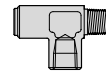

Side Tee Adapters
NPT, NPT Female
p. FIT-4-16

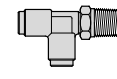

Side Tee Adapters NPT,
NPT Female
p. FIT-4-17



Special Tee Adapters
NPT Female, NPT
p. FIT-4-17

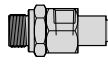

Special Hobbs Side Tee
Adapters Metric, NPT
Female p. FIT-4-17



Special 90° Tees
NPT p. FIT-4-18



90° Fixed Tees
p. FIT-4-(18-19)



Special 90° Bulkhead Tees
NPT Female
p. FIT-4-18



Special Bracketed Tee
Adapter, NPT Female
p. FIT-4-19



Union Tee's
NPT Female
p. FIT-4-20



Special Bracketed
Reducing Tee Connectors
p. FIT-4-21



Special Bulkhead Tees
UNF/SAE 45° Flare
p. FIT-4-21

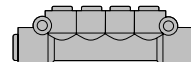

6 Port Manifold
p. FIT-4-21



Special Bulkhead Tees
UNF/SAE 45° Flare
p. FIT-4-13

FleetFit Vehicle Push-In Fittings

Dimensions in Inches (mm)



Male Connectors NPT

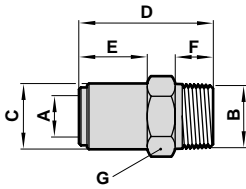

Part numbers ending with "V" have Viton seals.
*Special short 1/16" PTF-SAE short thread
5/32" fittings have a Pneufit style body and collet

SAE 630102

A Tube O.D.	B NPT	Product Number	ØC	D	E	F	G A/F
5/32"	1/16"	70 4542 02V	0.98 (25.0)	0.43 (11.0)	-	0.31 (8.0)	11/32"
5/32"	1/8"	70 4530 02V	0.30 (7.5)	0.89 (22.7)	-	0.37 (9.5)	7/16"
3/16"	1/8"	95 4530 03	0.46 (11.7)	1.02 (25.8)	0.43 (10.8)	0.37 (9.5)	1/2"
1/4"	1/8"	95 4530 04	0.50 (12.7)	1.04 (26.3)	0.43 (10.8)	0.37 (9.5)	1/2"
1/4"	1/4"	95 4530 10	0.50 (12.7)	1.17 (29.8)	0.37 (9.3)	0.56 (14.3)	9/16"
1/4"	3/8"	95 4530 18	0.50 (12.7)	1.20 (30.5)	0.31 (8.0)	0.56 (14.3)	11/16"
3/8"	1/8"	95 4530 06	0.65 (16.5)	1.32 (33.6)	0.67 (17.1)	0.37 (9.5)	11/16"
3/8"	1/4"	95 4530 12	0.66 (16.5)	1.48 (37.6)	0.63 (16.1)	0.56 (14.3)	11/16"
3/8"	3/8"	95 4530 20	0.66 (16.5)	1.42 (36.1)	0.54 (13.6)	0.56 (14.3)	11/16"
3/8"	1/2"	95 4530 29	0.66 (16.5)	1.46 (37.1)	0.36 (9.1)	0.75 (19.0)	7/8"
1/2"	1/4"	95 4530 13	0.79 (20.0)	1.68 (42.6)	0.75 (19.1)	0.56 (14.3)	7/8"
1/2"	3/8"	95 4530 21	0.79 (20.0)	1.64 (41.6)	0.71 (18.1)	0.56 (14.3)	7/8"
1/2"	1/2"	95 4530 30	0.79 (20.0)	1.72 (43.6)	0.61 (15.6)	0.75 (19.0)	7/8"
5/8"	3/8"	95 4530 22	0.98 (25.0)	1.87 (47.5)	0.89 (22.5)	0.56 (14.3)	1-1/16"
5/8"	1/2"	95 4530 31	0.98 (25.0)	2.12 (53.5)	0.93 (23.5)	0.75 (19.0)	1-1/16"
3/4"	1/2"	95 4530 49	1.00 (25.5)	2.11 (53.5)	0.89 (22.5)	0.75 (19.0)	1-3/16"

Male Connectors Metric

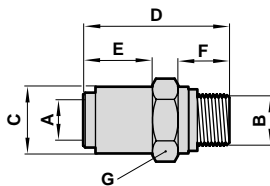

A Tube O.D.	B Thread Thread	Product Number	ØC	D	E	F	A/F
1/4"	M10 x 1.0	94 4666 31	0.51 (13.0)	1.12 (28.5)	0.53 (13.5)	0.39 (10.0)	0.55 (14)
1/4"	M12 x 1.5	94 4666 33	0.51 (13.0)	1.12 (30.5)	0.53 (11.5)	0.39 (12.0)	0.67 (17)
1/4"	M16 x 1.5	94 4666 35	0.51 (13.0)	1.12 (27.5)	0.53 (7.5)	0.39 (12.0)	0.87 (22)
1/4"	M22 x 1.5	94 4666 38	0.51 (13.0)	1.12 (30.5)	0.53 (5.0)	0.39 (14.5)	1.06 (27)
3/8"	M12 x 1.5	94 4666 53	0.51 (16.8)	1.12 (35.0)	0.53 (16.0)	0.39 (12.0)	0.67 (17)
3/8"	M14 x 1.5	94 4666 54	0.51 (16.8)	1.12 (35.0)	0.59 (15.0)	0.39 (12.0)	0.75 (19)
3/8"	M16 x 1.5	94 4666 55	0.67 (17.0)	1.38 (35.0)	0.59 (15.0)	0.47 (12.0)	0.87 (22)
3/8"	M22 x 1.5	94 4666 58	0.67 (17.0)	1.22 (31.0)	0.22 (5.5)	0.57 (14.5)	1.06 (27)
1/2"	M16 x 1.5	94 4666 65	0.81 (20.5)	1.54 (39.0)	0.75 (19.0)	0.47 (12.0)	0.87 (22)
1/2"	M20 x 1.5	94 4666 67	0.81 (20.5)	1.50 (38.0)	0.51 (13.0)	0.57 (14.5)	1.06 (27)
1/2"	M22 x 1.5	94 4666 68	0.81 (20.5)	1.38 (35.0)	0.37 (9.5)	0.57 (14.5)	1.06 (27)
5/8"	M22 x 1.5	94 4666 75	1.02 (26.0)	1.75 (44.5)	0.77 (19.5)	0.57 (14.5)	1.62 (27)



FleetFit Vehicle Push-In Fittings

Dimensions in Inches (mm)

Male Connectors BSP Taper

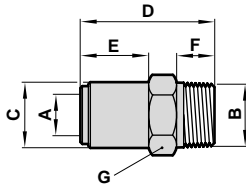

A Tube O.D.	B BSP Taper	Product Number	ØC	D	E	F	G A/F
1/4"	1/8"	94 4530 04	0.50 (12.7)	1.04 (26.3)	0.41 (10.3)	0.37 (9.5)	0.51 (13)
1/4"	1/4"	94 4530 10	0.50 (12.7)	1.06 (26.8)	0.37 (9.3)	0.44 (11.1)	0.55 (14)
3/8"	1/8"	94 4530 06	0.65 (16.5)	1.31 (33.3)	0.67 (17.1)	0.37 (9.5)	0.67 (17)
3/8"	1/4"	94 4530 12	0.79 (20)	1.55 (39.3)	0.75 (19.1)	0.44 (11.1)	0.87 (22)
3/8"	3/8"	94 4530 20	0.65 (16.5)	1.35 (34.3)	0.54 (13.6)	0.50 (12.7)	0.67 (17)
3/8"	1/2"	94 4530 29	0.65 (16.5)	1.33 (33.8)	0.36 (9.1)	0.63 (15.9)	0.87 (22)
1/2"	1/4"	94 4530 13	0.79 (20)	1.55 (39.3)	0.75 (19.1)	0.44 (11.1)	0.87 (22)
1/2"	3/8"	94 4530 21	0.79 (20)	1.57 (39.8)	0.71 (18.1)	0.50 (12.7)	0.87 (22)
1/2"	1/2"	94 4530 30	0.79 (20)	1.59 (40.3)	0.61 (15.6)	0.63 (15.9)	0.87 (22)
5/8"	1/2"	94 4530 31	0.98 (25)	1.99 (50.5)	0.93 (23.5)	0.63 (15.9)	1.06 (27)

Male Connectors UNF / SAE 45° Flare

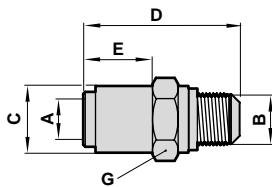

A Tube O.D.	B UNF	Product Number	C	D	E	G A/F
1/4"	7/16	94 4611 03	1.32 (33.5)	0.47 (12)	0.51 (13)	0.55 (14)
3/8"	5/8"	94 4611 01	1.59 (40.5)	0.59 (15)	0.63 (16)	0.67 (17)
1/2"	1/2"	94 4612 01	1.57 (40)	0.79 (20)	0.43 (11)	0.87 (22)
1/2"	3/4"	94 4611 02	1.85 (47)	0.63 (16)	0.75 (19)	0.87 (22)
5/8"	7/8"	94 4611 06	2.19 (55.5)	0.75 (19)	0.89 (22.5)	1.06 (27)

Extended Straight Adapters NPT Male

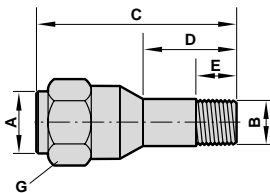

A Tube O.D.	B NPT	Product Number	ØC	D	E	G A/F
3/8"	1/8"	95 4490 06	1.85 (47.0)	0.87 (22.0)	0.37 (9.5)	11/16"

Female Connectors NPT Female

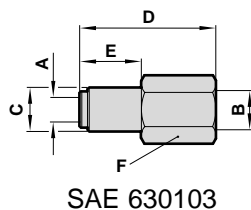

A Tube O.D.	B NPT	Product Number	ØC	D	E	F A/F
1/4"	1/8"	95 4355 04	0.51 (13)	1.31 (33.3)	0.72 (18.3)	9/16"
1/4"	1/4"	95 4355 10	0.51 (13)	1.59 (40.3)	0.72 (18.3)	11/16"
3/8"	1/8"	95 4355 06	0.67 (17)	1.50 (38)	0.91 (23)	11/16"
3/8"	1/4"	95 4355 12	0.65 (16.5)	1.74 (44.3)	0.88 (22.3)	11/16"
3/8"	3/8"	95 4355 20	0.65 (16.5)	1.78 (45.3)	0.88 (22.3)	7/8"
1/2"	1/2"	95 4355 30	0.91 (23)	2.11 (53.5)	0.96 (24.5)	11/16"



Female Connectors UNF

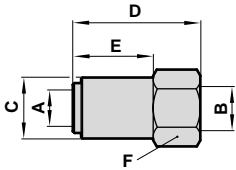

A Tube O.D.	B UNF	Product Number	Ø C	D	E	F A/F
3/8"	5/8"	94 4603 02	0.71 (18.0)	1.50 (38.0)	0.94 (24.0)	0.75 (19.0)
3/8"	3/4"	94 4603 03	0.71 (18.0)	1.69 (43.0)	1.02 (26.0)	0.94 (24.0)
1/2"	3/4"	94 4603 01	0.87 (22.0)	1.81 (46.0)	1.14 (29.0)	0.94 (24.0)
5/8"	7/8"	94 4603 04	1.04 (26.5)	2.01 (51.0)	1.20 (30.5)	1.06 (27.0)

Unions Inch

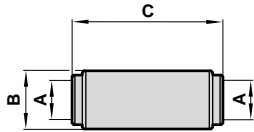

5/32" fittings have a Pneufit style body and collet

SAE 630101

A Tube O.D.	Product Number	ØB	C
5/32"	71 4503 02	0.39 (10.0)	1.18 (30.0)
3/16"	94 4503 13	0.47 (12.0)	1.36 (34.6)
1/4"	94 4503 04	0.51 (13.0)	1.40 (35.6)
3/8"	94 4503 06	0.67 (17.0)	1.74 (44.1)
1/2"	94 4503 07	0.81 (20.5)	2.01 (51.1)
5/8"	94 4503 08	1.00 (25.4)	2.42 (61.5)
3/4"	94 4503 09	1.18 (30.0)	2.48 (63.0)

Reducing Unions Inch

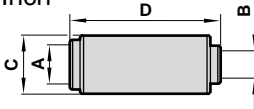

SAE 630101

A Tube O.D.	B Tube Tube	Product Number	ØC	D
3/8"	1/4"	94 4504 48	0.67 (17.0)	1.71 (43.5)
1/2"	3/8"	94 4504 64	0.81 (20.5)	1.91 (48.5)

Bulkhead Unions Metric

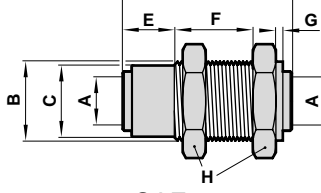

SAE 630601

A Tube O.D.	B Thread	Panel Hole ø	Product Number	Ø C	D	E	F (Max)	G (Min)	H A/F
1/4"	M15 x 1.0	0.61 (15.5)	94 4507 04	-	1.41 (35.9)	-	0.87 (22.0)	0.08 (2.0)	0.87 (22.0)
3/8"	M20 x 1.5	0.81 (20.5)	94 4507 06	0.70 (17.7)	1.75 (44.5)	0.33 (8.5)	0.87 (22.0)	0.08 (2.0)	1.06 (27.0)
1/2"	M24 x 1.5	0.97 (24.5)	94 4507 07	0.85 (21.7)	2.02 (51.4)	0.63 (16.0)	0.87 (22.0)	0.08 (2.0)	1.18 (30.0)

Female Bulkhead Connectors NPT Female, UNF

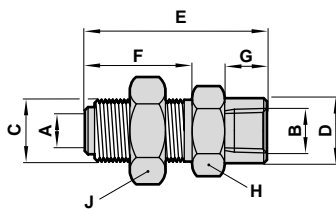

A Tube O.D.	B NPT Female	C UNF	Product Number	ØD	E	F	G	H A/F	J A/F
1/4"	1/8"	5/8"	95 4570 06	0.63 (16.0)	1.32 (33.5)	0.69 (17.5)	0.28 (7.0)	0.87 (22.0)	15/16"
1/4"	1/4"	5/8"	95 4570 01	0.79 (20.0)	1.59 (40.5)	0.73 (18.5)	0.51 (13.0)	0.87 (22.0)	15/16"
3/8"	1/4"	3/4"	95 4570 03	0.79 (20.0)	2.20 (56.0)	1.30 (33.0)	0.51 (13.0)	0.94 (24.0)	1-1/8"
3/8"	3/8"	3/4"	95 4570 04	0.79 (20.0)	2.20 (56.0)	1.30 (33.0)	0.51 (13.0)	0.94 (24.0)	1-1/8"
3/8"	1/2"	3/4"	95 4570 02	-	2.40 (61.0)	1.30 (33.0)	-	1.06 (27)	1-1/8"
1/2"	3/8"	7/8"	95 4570 05	-	1.89 (48.0)	1.50 (38.0)	-	1.06 (27)	1-5/16"
1/2"	1/2"	7/8"	95 4570 07	-	2.64 (67.0)	1.50 (38.0)	-	1.06 (27)	1-5/16"



FleetFit Vehicle Push-In Fittings

Dimensions in Inches (mm)

Male Bulkhead Connectors Metric, Metric

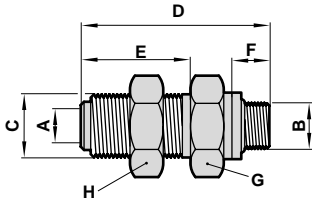

A Tube O.D.	B Thread	Panel Hole ø	C Thread	Product	D	E	F	G A/F	H A/F
3/8"	M16 x 1.5	0.65 (16.5)	M20 x 1.5	94 4642 05	1.95 (49.5)	1.20 (30.5)	0.39 (10.0)	1.06 (27.0)	1.06 (27.0)
3/8"	M20 x 1.5	0.8 (20.5)	M20 x 1.5	94 4642 01	2.36 (60.0)	1.38 (35.0)	0.47 (12.0)	1.06 (27.0)	1.06 (27.0)
1/2"	M24 x 1.5	0.97 (24.5)	M24 x 1.5	94 4642 04	2.01 (51.0)	1.22 (31.0)	0.39 (10.0)	1.18 (30.0)	1.18 (30.0)

Note: Supplied complete with two locknuts. This connector can also be ordered with one locknut only (to order quote series 94 4508 88 and size).

Male Bulkhead Connectors BSP Taper, Metric

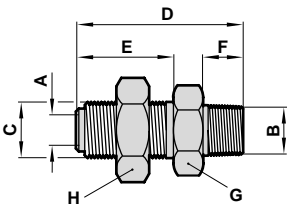

A Tube O.D.	B BSP Taper	C Thread	Panel Hole ø	Product Number	D	E	F	G A/F	H A/F
3/8"	1/2"	M20 x 1.5	0.81 (20.5)	94 4652 01	2.11 (53.5)	1.20 (30.5)	0.63 (15.9)	1.06 (27.0)	1.06 (27.0)
1/2"	1/2"	M24 x 1.5	0.97 (24.5)	94 4652 02	2.13 (54.0)	1.22 (31.0)	0.63 (15.9)	1.06 (27.0)	1.18 (30.0)

Straight Bulkhead Adapters UNF / SAE 45° Flare

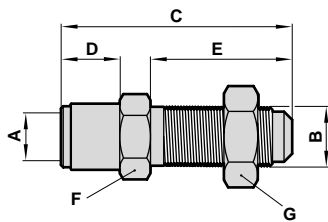

A Tube O.D.	B UNF	Product Number	C	D	E	F A/F	G A/F
1/4"	7/16"	94 4602 03	1.99 (50.5)	0.57 (14.5)	1.18 (30.0)	0.67 (17.0)	11/16"
3/8"	5/8"	94 4602 02	2.80 (71.0)	0.71 (18.0)	1.81 (46.0)	0.87 (22.0)	15/16"
1/2"	3/4"	94 4602 01	2.93 (74.5)	0.75 (19.0)	1.81 (46.0)	0.94 (24.0)	1-1/8"

Additional Bulkhead Nuts

Bulkheads include lock nuts. Refer to the numbers below to order additional nuts.		
Thread	Part Number	A/F
M12 X 1.0	95 0520 01	—
M15 X 1.0	95 0520 03	0.87 (22.0)
M20 X 1.5	95 0520 06	1.06 (27.0)
M24 X 1.5	95 0520 07	1.18 (30.0)



Plug*

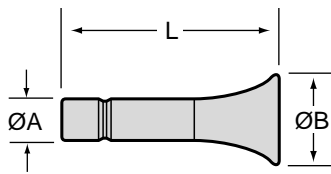

SAE 630109

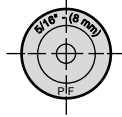

A Stem O.D.	Part Number	ØB	L
1/4"	94 0509 04	0.46 (11.6)	1.12 (28.5)
3/8"	94 0509 06	0.65 (16.6)	1.34 (34.0)
1/2"	94 0509 07	0.65 (16.4)	1.48 (37.5)

*Material: Thermoplastic

Male Elbows NPT

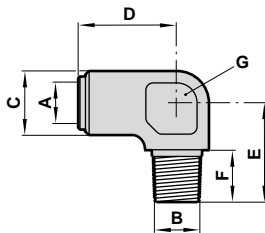

SAE 630202

A Tube O.D.	B NPT	Product Number	ØC	D	E	F	G A/F
5/32"	1/8"	70 4331 02V	0.30 (7.5)	0.67 (17.0)	.068 (17.2)	0.37 (9.5)	0.28 (7.0)
3/16"	1/8"	95 4331 03	0.47 (12.0)	0.81 (20.5)	0.75 (19.0)	0.37 (9.5)	0.47 (12.0)
1/4"	1/8"	95 4331 04	0.55 (14.0)	0.81 (20.5)	0.79 (20.0)	0.37 (9.5)	0.55 (14.0)
1/4"	1/4"	95 4331 10	0.69 (17.5)	0.87 (22.0)	1.02 (26.0)	0.56 (14.3)	0.71 (18.0)
1/4"	3/8"	95 4331 18	0.82 (20.8)	0.94 (24.0)	1.10 (28.0)	0.56 (14.3)	0.87 (22.0)
1/4"	1/2"	95 4331 27	0.94 (24.0)	0.96 (24.5)	1.38 (35.0)	0.75 (19.1)	0.94 (24.0)
5/16"	1/8"	95 4331 05	0.69 (17.5)	0.89 (22.5)	0.94 (24.0)	0.37 (9.5)	0.71 (18.0)
3/8"	1/8"	95 4331 06	0.69 (17.5)	1.08 (27.5)	0.87 (22.0)	0.37 (9.5)	0.71 (18.0)
3/8"	1/4"	95 4331 12	0.69 (17.5)	1.06 (27.0)	1.02 (26.0)	0.56 (14.3)	0.71 (18.0)
3/8"	3/8"	95 4331 20	0.82 (20.8)	1.14 (29.0)	1.10 (28.0)	0.56 (14.3)	0.87 (22.0)
3/8"	1/2"	95 4331 29	0.94 (24.0)	1.14 (29.0)	1.38 (35.0)	0.75 (19.1)	0.94 (24.0)
1/2"	1/4"	95 4331 13	0.87 (22.0)	1.22 (31.0)	1.14 (29.0)	0.56 (14.3)	0.87 (22.0)
1/2"	3/8"	95 4331 21	0.87 (22.0)	1.26 (32.0)	1.14 (29.0)	0.56 (14.3)	0.87 (22.0)
1/2"	1/2"	95 4331 30	0.94 (24.0)	1.28 (32.5)	1.38 (35.0)	0.75 (19.1)	0.94 (24.0)
1/2"	3/4"	95 4331 44	1.15 (29.3)	1.46 (37.0)	1.50 (38.0)	0.75 (19.1)	1.18 (30.0)
5/8"	3/8"	95 4331 98	1.06 (27.0)	1.44 (36.5)	1.22 (31.0)	0.56 (14.3)	0.87 (22.0)
5/8"	1/2"	95 4331 31	1.15 (29.3)	1.54 (39.0)	1.42 (36.0)	0.75 (19.1)	1.18 (30.0)
3/4"	1/2"	95 4331 49	1.30 (33.0)	1.52 (38.5)	1.48 (37.5)	0.75 (19.1)	0.94 (24.0)

Part numbers ending with a "V" have Viton seals.
5/32" fittings have a Pneufit stylebody and collet.



FleetFit Vehicle Push-In Fittings

Dimensions in Inches (mm)

Male Hobbs Elbows Metric

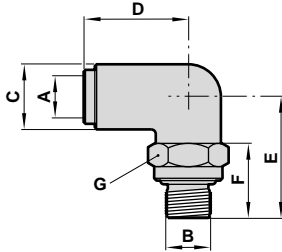

A Tube O.D.	B Thread	Product Number	ØC	D	E	F	G A/F
1/4"	M12 x 1.0	94 4138 32	0.55 (14.0)	0.93 (23.5)	1.14 (29.0)	0.75 (19.0)	0.67 (17.0)
1/4"	M12 x 1.5	94 4138 33	0.55 (14.0)	0.93 (23.5)	1.14 (29.0)	0.75 (19.0)	0.67 (17.0)
1/4"	M16 x 1.5	94 4138 35	0.69 (17.5)	0.96 (24.5)	1.34 (34.0)	0.85 (21.5)	0.94 (24.0)
1/4"	M22 x 1.5	94 4138 38	1.02 (26.0)	1.12 (28.5)	1.63 (41.5)	0.98 (25.0)	1.18 (30.0)
3/8"	M12 x 1.5	94 4138 53	0.73 (18.5)	1.14 (29.0)	1.22 (31.0)	0.75 (19.0)	0.67 (17.0)
3/8"	M14 x 1.5	94 4138 54	0.73 (18.5)	1.10 (28.0)	1.24 (31.5)	0.77 (19.5)	0.75 (19.0)
3/8"	M16 x 1.5	94 4138 55	0.73 (18.5)	1.14 (29.0)	1.32 (33.5)	0.85 (21.5)	0.94 (24.0)
3/8"	M22 x 1.5	94 4138 58	1.02 (26.0)	1.26 (32.0)	1.59 (40.5)	0.98 (25.0)	1.18 (30.0)
1/2"	M14 x 1.5	94 4138 64	0.87 (22.0)	1.28 (32.5)	1.32 (33.5)	0.77 (19.5)	0.75 (19.0)
1/2"	M16 x 1.5	94 4138 65	0.87 (22.0)	1.28 (32.5)	1.40 (35.5)	0.85 (21.5)	0.94 (24.0)
1/2"	M22 x 1.5	94 4138 68	1.02 (26.0)	1.36 (34.5)	1.59 (40.5)	0.98 (25.0)	1.18 (30.0)

Male Elbows BSP Taper

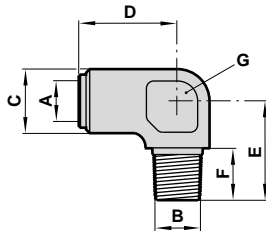

A Tube O.D.	B BSP Taper	Product Number	ØC	D	E	F	G GA/F
1/4"	1/8"	94 4330 04	0.56 (14.3)	0.81 (20.5)	0.79 (20.0)	0.37 (9.5)	0.55 (14.0)
1/4"	1/4"	94 4330 10	0.63 (15.9)	0.86 (21.8)	0.87 (22.0)	0.44 (11.1)	-
3/8"	1/4"	94 4330 12	0.69 (17.5)	0.99 (25.1)	0.94 (24.0)	0.44 (11.1)	-
3/8"	3/8"	94 4330 20	0.79 (20.0)	1.03 (26.1)	1.08 (27.5)	0.50 (12.7)	-
3/8"	1/2"	94 4330 29	0.94 (23.8)	1.19 (30.1)	1.22 (31.0)	0.63 (15.9)	-
1/2"	1/4"	94 4330 13	0.94 (23.8)	1.19 (30.1)	1.06 (27.0)	0.44 (11.1)	-
1/2"	3/8"	94 4330 21	0.94 (23.8)	1.19 (30.1)	1.12 (28.5)	0.50 (12.7)	-
1/2"	1/2"	94 4330 30	0.94 (23.8)	1.20 (30.6)	1.22 (31.0)	0.63 (15.9)	-



Male Swivel Elbows NPT

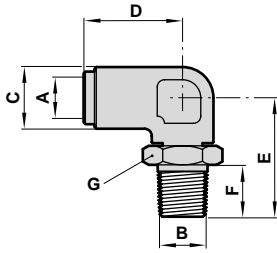

SAE 6302AA

A Tube O.D.	B NPT	Product Number	ØC	D	E	F	G A/F
1/4"	1/8"	95 4114 04	0.51 (13.0)	0.83 (21.2)	0.91 (23.2)	0.37 (9.5)	0.43 (11.0)
1/4"	1/4"	95 4114 10	0.51 (13.0)	0.83 (21.2)	1.12 (28.4)	0.56 (14.3)	0.55 (14.0)
1/4"	3/8"	95 4114 18	0.59 (15.0)	0.85 (21.5)	1.25 (31.7)	0.56 (14.3)	0.75 (19.0)
3/8"	1/8"	95 4114 06	0.67 (17.0)	1.07 (27.3)	1.05 (26.7)	0.37 (9.5)	0.55 (14.0)
3/8"	1/4"	95 4114 12	0.67 (17.0)	1.07 (27.3)	1.29 (32.7)	0.56 (14.3)	0.75 (19.0)
3/8"	3/8"	95 4114 20	0.67 (17.0)	1.07 (27.3)	1.24 (31.6)	0.56 (14.3)	0.75 (19.0)
3/8"	1/2"	95 4114 29	0.67 (17.0)	1.07 (27.3)	1.44 (36.8)	0.75 (19.0)	0.87 (22.0)
1/2"	1/4"	95 4114 13	0.81 (20.6)	1.27 (32.3)	1.27 (32.2)	0.56 (14.3)	0.87 (22.0)
1/2"	3/8"	95 4114 21	0.81 (20.6)	1.27 (32.3)	1.42 (36.1)	0.56 (14.3)	0.87 (22.0)
1/2"	1/2"	95 4114 30	0.81 (20.6)	1.27 (32.3)	1.62 (41.1)	0.75 (19.0)	0.87 (22.0)

Note: The Swivel feature should be used for positioning purposes only and should not be used as a rotating joint.

45° Male Elbows NPT

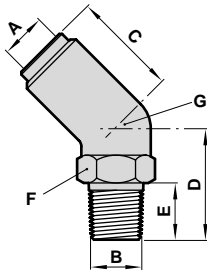

SAE 630302

A Tube O.D.	B NPT	Product Number	C	D	E	F A/F	G A/F
1/4"	1/8"	95 4600 04	0.87 (22.0)	0.81 (20.5)	0.37 (9.5)	0.56 (14.3)	-
1/4"	1/4"	95 4600 10	0.89 (22.5)	0.98 (25.0)	0.56 (14.3)	0.56 (14.3)	-
3/8"	1/8"	95 4600 06	1.02 (26.0)	0.93 (23.5)	0.37 (9.5)	0.75 (19.0)	-
3/8"	1/4"	95 4600 12	1.06 (27.0)	1.10 (28.0)	0.56 (14.3)	0.75 (19.0)	-
3/8"	3/8"	95 4600 20	1.10 (28.0)	1.12 (28.5)	0.56 (14.3)	0.75 (19.0)	-
3/8"	1/2"	95 4600 29	1.14 (29.0)	1.30 (33.0)	0.75 (19.1)	0.87 (22.0)	-
1/2"	1/4"	95 4600 13	1.22 (31.0)	1.10 (28.0)	0.56 (14.3)	0.87 (22.0)	-
1/2"	3/8"	95 4600 21	1.26 (32.0)	1.12 (28.5)	0.56 (14.3)	0.87 (22.0)	-
1/2"	1/2"	95 4600 30	1.30 (33.0)	1.30 (33.0)	0.75 (19.1)	0.87 (22.0)	-
5/8"	3/8"	95 4600 22	1.46 (37.0)	1.02 (26.0)	0.56 (14.3)	-	1.06 (27.0)
5/8"	1/2"	95 4600 31	1.46 (37.0)	1.22 (31.0)	0.75 (19.1)	-	1.06 (27.0)
3/4"	1/2"	95 4600 49	1.52 (38.5)	1.30 (33.0)	0.75 (19.1)	1.00 (25.4)	-

45° Male Hobbs Elbows Metric

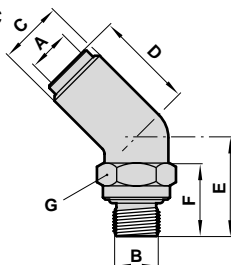

A Tube O.D.	B Thread	Product Number	ØC	D	E	F	G A/F
1/4"	M16 x 1.5	94 4301 35	0.69 (17.5)	0.96 (24.5)	1.16 (29.5)	0.85 (21.5)	0.94 (24.0)
3/8"	M16 x 1.5	94 4301 55	0.69 (17.5)	1.16 (29.5)	1.16 (29.5)	0.85 (21.5)	0.94 (24.0)



FleetFit Vehicle Push-In Fittings

Dimensions in Inches (mm)

Female Elbows

NPT

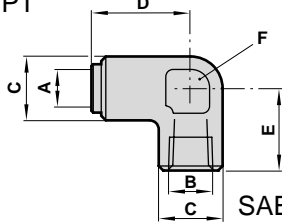

SAE 630203

A Tube O.D.	B NPT	Product Number	ØC	D	E	F A/F
3/16"	1/8"	95 4564 01	0.55 (14.0)	0.87 (22.0)	0.71 (18.0)	0.55 (14.0)
1/4"	1/8"	95 4562 04	0.55 (14.0)	0.94 (24.0)	0.71 (18.0)	0.55 (14.0)

45° Female Elbows

NPT

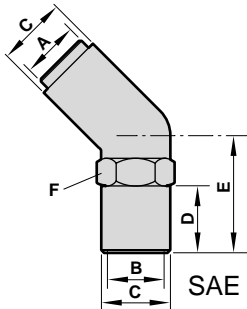

SAE 630303

A Tube O.D.	B NPT	Product Number	ØC	D	E	F A/F
3/8"	1/8"	95 4470 06	0.70 (17.7)	0.59 (1.5)	0.57 (14.5)	0.75 (19.0)

Union Elbows

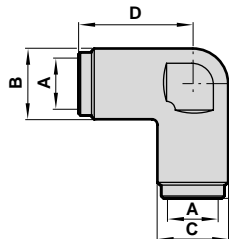

SAE 630201

A Tube O.D.	Product Number	ØB	ØC	D
1/4"	94 4511 04	0.43 (11.0)	0.51 (13.0)	0.83 (21.0)
3/8"	94 4511 06	0.57 (14.5)	0.67 (17.0)	1.07 (27.1)
1/2"	94 4511 07	0.71 (18.0)	0.81 (20.5)	1.26 (32.1)

Union Bulkhead Elbows

Metric

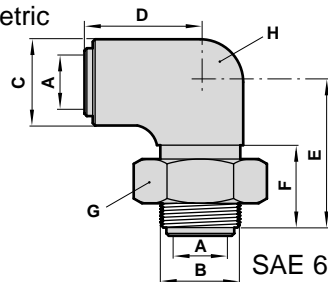

SAE 630701

A Tube O.D.	B Thread	Product Number	Panel Hole ø	ØC	D	E	F	G A/F	H A/F
1/4"	M15 x 1.0	94 4591 04	0.6 (15.5)	0.69 (17.5)	0.85 (21.5)	1.12 (28.5)	0.65 (16.5)	0.87 (22.0)	0.71 (18.0)
3/8"	M20 x 1.5	94 4591 06	0.8 (20.5)	0.94 (23.8)	1.08 (27.5)	1.54 (39.0)	0.89 (22.5)	1.06 (27.0)	-
1/2"	M24 x 1.5	94 4591 07	0.96 (26.5)	1.06 (27.0)	1.28 (32.5)	1.54 (39.0)	0.89 (22.5)	1.18 (30.0)	1.06 (27.0)

Male Bulkhead Elbows

NPT Female, UNF

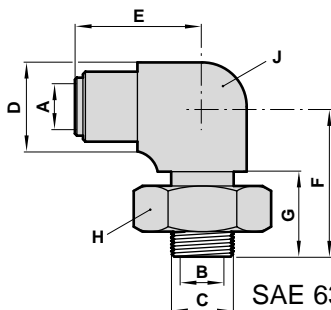

SAE 631403

A Tube O.D.	B NPT Female	C UNF	Product Number	ØD	E	F	G	H A/F	J A/f
1/4"	1/8"	5/8"	95 4597 04	0.81 (20.7)	1.00 (25.5)	1.18 (30.0)	0.63 (16.0)	15/16"	0.87 (22.0)
3/8"	3/8"	7/8"	95 4597 01	1.02 (26.0)	1.17 (29.7)	1.61 (41.0)	0.98 (25.0)	1-5/16"	0.67 (17.0)
1/2"	3/8"	7/8"	95 4597 02	1.02 (26.0)	1.33 (33.7)	1.61 (41.0)	0.98 (25.0)	1-5/16"	0.67 (17.0)
5/8"	3/8"	7/8"	95 4597 03	1.02 (26.0)	1.48 (37.5)	1.61 (41.0)	0.98 (25.0)	1-5/16"	0.67 (17.0)



Double Elbow Adapters NPT

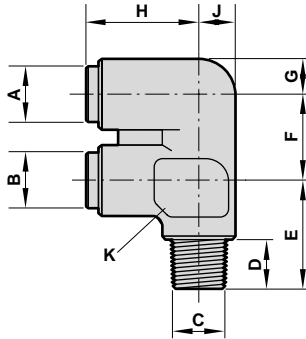

A Tube O.D.	B Tube O.D.	C NPT	Product Number	D	E	F	G	H	J	K A/F
1/4"	1/4"	1/8"	95 4761 01	0.37 (9.5)	0.83 (21.0)	0.67 (17.0)	0.28 (7.0)	0.89 (22.5)	0.28 (7.0)	0.55 (14.0)

Bulkhead Elbow Adapters UNF / SAE 45° Flare

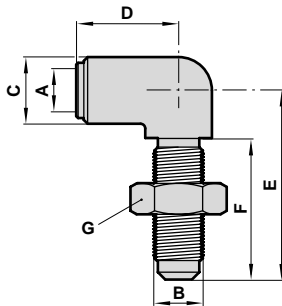

Tube O.D.	B UNF	Product Number	ØC	D	E	F	G A/F
1/4"	7/16"	94 4607 05	0.56 (14.3)	0.85 (21.5)	1.57 (40.0)	1.18 (30.0)	1-1/16"
3/8"	5/8"	94 4607 02	0.98 (25.0)	1.10 (28.0)	2.44 (62.0)	1.81 (46.0)	1-5/16"
1/2"	5/8"	94 4607 03	0.98 (25.0)	1.26 (32.0)	2.44 (62.0)	1.81 (46.0)	1-5/16"
1/2"	3/4"	94 4607 04	0.98 (25.0)	1.26 (32.0)	2.44 (62.0)	1.81 (46.0)	1-1/8"

Male Branch Tees NPT

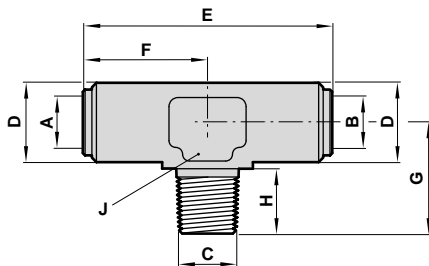

SAE 630425

A Tube O.D.	B Tube O.D.	C NPT	Product Number	ØD	E	F	G	H	J A/F
1/4"	1/4"	1/8"	95 4590 02	0.55 (14.0)	1.69 (43.0)	0.85 (21.5)	0.79 (20.0)	0.37 (9.5)	0.55 (14.0)
1/4"	1/4"	1/4"	95 4590 12	0.69 (17.5)	1.77 (45.0)	0.89 (22.5)	0.96 (24.5)	0.56 (14.3)	0.71 (18.0)
1/4"	1/4"	3/8"	95 4590 19	0.82 (20.8)	1.93 (49.0)	0.96 (24.5)	1.10 (28.0)	0.56 (14.3)	0.87 (22.0)
3/8"	1/4"	1/4"	95 4590 16	0.69 (17.5)	1.97 (50.0)	0.89 (22.5)	0.96 (24.5)	0.56 (14.3)	0.71 (18.0)
3/8"	3/8"	1/4"	95 4590 10	0.69 (17.5)	2.17 (55.0)	1.08 (27.5)	0.96 (24.5)	0.56 (14.3)	0.71 (18.0)
3/8"	3/8"	3/8"	95 4590 01	0.82 (20.8)	2.28 (58.0)	1.14 (29.0)	1.10 (28.0)	0.56 (14.3)	0.87 (22.0)
1/2"	1/4"	1/4"	95 4590 09	0.87 (22.0)	2.15 (54.5)	0.93 (23.5)	1.14 (29.0)	0.56 (14.3)	0.87 (22.0)
1/2"	1/4"	3/8"	95 4590 06	0.87 (22.0)	2.26 (57.5)	0.96 (24.5)	1.14 (29.0)	0.56 (14.3)	0.87 (22.0)
1/2"	1/4"	1/2"	95 4590 08	0.91 (23.0)	2.34 (59.5)	1.00 (25.5)	1.42 (36.0)	0.75 (19.1)	0.94 (24.0)
1/2"	3/8"	1/2"	95 4590 14	0.87 (22.0)	2.48 (63.0)	1.18 (30.0)	1.22 (31.0)	0.75 (19.1)	0.87 (22.0)
1/2"	1/2"	1/4"	95 4590 13	0.87 (22.0)	2.44 (62.0)	1.22 (31.0)	1.14 (29.0)	0.56 (14.3)	0.87 (22.0)
1/2"	1/2"	3/8"	95 4590 05	0.87 (22.0)	2.60 (66.0)	1.30 (33.0)	1.14 (29.0)	0.56 (14.3)	0.87 (22.0)
1/2"	1/2"	1/2"	95 4590 04	0.91 (23.0)	2.68 (68.0)	1.34 (34.0)	1.42 (36.0)	0.75 (19.1)	0.94 (24.0)
5/8"	1/2"	3/8"	95 4590 15	1.14 (29.0)	2.78 (70.5)	1.30 (33.0)	1.26 (32.0)	0.56 (14.3)	1.18 (30.0)
5/8"	1/2"	1/2"	95 4590 07	1.14 (29.0)	2.78 (70.5)	1.30 (33.0)	1.46 (37.0)	0.75 (19.1)	1.18 (30.0)



FleetFit Vehicle Push-In Fittings

Dimensions in Inches (mm)

Hobbs Tee Adapters Metric

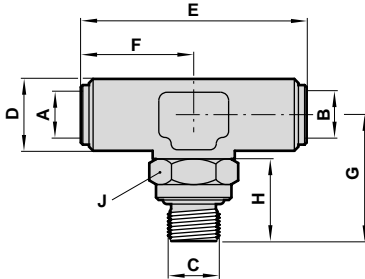

A Tube O.D.	B Tube O.D.	C Thread	Product Number	D	E	F	G	H	J A/F
1/4"	1/4"	M16 x 1.5	94 4439 15	0.71 (18.0)	1.89 (48.0)	0.94 (24.0)	1.32 (33.5)	0.85 (21.5)	0.94 (24.0)
1/2"	1/2"	M22 x 1.5	94 4639 06	0.87 (22.0)	2.83 (72.0)	1.42 (36.0)	1.69 (43.0)	0.98 (25.0)	1.06 (27.0)

Male Branch Tees BSP Taper

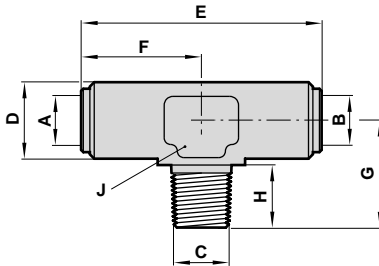

A Tube O.D.	B Tube O.D.	C BSP Taper	Product Number	ØD	E	F	G	H	J A/F
1/4"	1/4"	1/4"	94 4590 12	0.55 (14.0)	1.69 (43.0)	0.85 (21.5)	0.81 (20.5)	0.44 (11.1)	0.55 (14.0)
3/8"	3/8"	1/4"	94 4590 10	0.69 (17.4)	2.17 (55.0)	1.08 (27.5)	0.93 (23.5)	0.44 (11.1)	0.71 (18.0)

Special Tee Adapters NPT, NPT Female

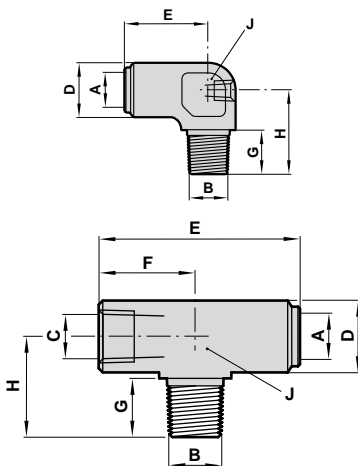

A Tube O.D.	B NPT	NPT Female	Product Number	ØD	E	F	G	H	J A/F
3/8"	1/4"	1/4"	95 4593 09	0.69 (17.4)	2.05 (52.0)	0.96 (24.5)	0.56 (14.3)	0.96 (24.5)	0.71 (18.0)
3/8"	3/8"	1/4"	95 4593 11	0.82 (20.8)	1.89 (48.0)	0.75 (19.0)	0.56 (14.3)	1.10 (28.0)	0.87 (22.0)
3/8"	1/2"	1/4"	95 4593 03	0.91 (23.0)	2.20 (56.0)	0.98 (25.0)	0.75 (19.1)	1.42 (36.0)	0.94 (24.0)
1/2"	3/8"	1/4"	95 4593 07	0.87 (22.0)	2.24 (57.0)	0.94 (24.0)	0.56 (14.3)	1.14 (29.0)	0.87 (22.0)
1/2"	1/2"	1/8"	95 4593 06*	0.94 (24.0)	1.28 (32.5)	-	0.75 (19.1)	1.38 (35.0)	0.94 (24.0)
1/2"	1/2"	1/4"	95 4593 02	0.91 (23.0)	2.32 (59.0)	0.98 (25.0)	0.75 (19.1)	1.42 (36.0)	0.94 (24.0)

*Top diagram refers to 95 4593 06.



Universal Hobbs Tee Adapters Metric, NPT Female

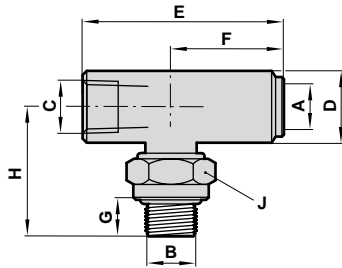

A Tube O.D.	B Thread	C NPT Female	Product Number	ØD	E	F	G	H	J A/F
3/8"	M16 x 1.5	1/4"	95 4621 03	0.75 (19.0)	2.07 (52.5)	1.12 (28.5)	0.41 (10.5)	1.32 (33.5)	0.87 (22.0)
3/8"	M22 x 1.5	1/4"	95 4621 02	0.87 (22.0)	2.20 (56.0)	1.26 (32.0)	0.51 (13.0)	1.69 (43.0)	1.06 (27.0)
1/2"	M22 x 1.5	1/4"	95 4621 01	0.87 (22.0)	2.36 (60.0)	1.42 (36.0)	0.51 (13.0)	1.69 (43.0)	1.06 (27.0)

Male Swivel Branch Tees NPT

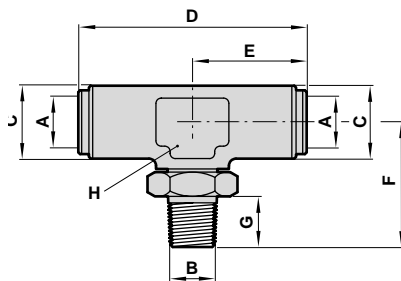

SAE 6304AC

CAUTION: Swivel Adapters are not suitable for use in continuously rotating or gyrating applications.

A Tube O.D.	B NPT	Product Number	ØC	D	E	F	G	H A/F
1/4"	1/8"	95 4111 04	0.51 (13.0)	1.67 (42.4)	0.83 (21.2)	0.91 (23.2)	0.37 (9.5)	0.43 (11.0)
1/4"	1/4"	95 4111 10	0.51 (13.0)	1.67 (42.4)	0.83 (21.2)	1.12 (28.4)	0.56 (14.3)	0.55 (14.0)
3/8"	1/4"	95 4111 12	0.67 (17.0)	2.17 (55.0)	1.08 (27.5)	1.29 (32.7)	0.56 (14.3)	0.75 (19.0)
3/8"	3/8"	95 4111 20	0.67 (17.0)	2.17 (55.0)	1.08 (27.5)	1.24 (31.6)	0.56 (14.3)	0.75 (19.0)
1/2"	1/4"	95 4111 13	0.81 (20.6)	2.56 (65.0)	1.28 (32.5)	1.39 (35.2)	0.56 (14.3)	0.87 (22.0)
1/2"	1/2"	95 4111 30	0.81 (20.6)	2.56 (65.0)	1.28 (32.5)	1.62 (41.1)	0.75 (19.1)	0.87 (22.0)

Tee Adapters Metric

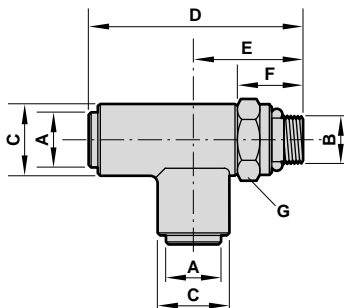

A Tube O.D.	B NPT	Product Number	ØC	D	E	F	G A/F
1/4"	M12 x M15	94 4440 20	0.55 (14.0)	2.07 (52.5)	1.14 (29.0)	0.75 (19.0)	0.67 (17.0)



FleetFit Vehicle Push-In Fittings

Dimensions in Inches (mm)

Male Run Tees NPT

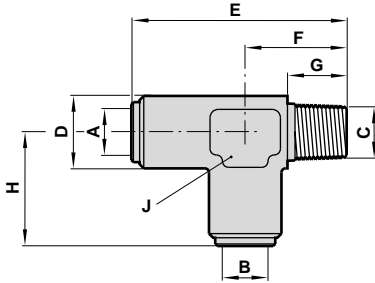

SAE 630424

A Tube O.D.	B Tube O.D.	C NPT	Product Number	ØD	E	F	G	H	J A/F
1/4"	1/4"	1/8"	95 4586 28	0.55 (14.0)	1.67 (42.5)	0.79 (20.0)	0.37 (9.5)	0.89 (22.5)	0.55 (14.0)
1/4"	1/4"	1/4"	95 4586 13	0.69 (17.5)	1.85 (47.0)	0.96 (24.5)	0.56 (14.3)	0.89 (22.5)	0.71 (18.0)
1/4"	1/4"	3/8"	95 4586 17	0.82 (20.8)	2.03 (51.5)	1.10 (28.0)	0.56 (14.3)	0.93 (23.5)	0.87 (22.0)
1/4"	3/8"	1/4"	95 4586 21	0.69 (17.5)	1.85 (47.0)	0.96 (24.5)	0.56 (14.3)	1.08 (27.5)	0.71 (18.0)
1/4"	3/8"	3/8"	95 4586 07	0.82 (20.8)	2.03 (51.5)	1.10 (28.0)	0.56 (14.3)	1.14 (29.0)	0.87 (22.0)
1/4"	1/2"	3/8"	95 4586 06	0.87 (22.0)	2.11 (53.5)	1.14 (29.0)	0.56 (14.3)	1.30 (33.0)	0.87 (22.0)
1/4"	1/2"	1/2"	95 4586 18	0.91 (23.0)	2.34 (59.5)	1.42 (36.0)	0.75 (19.1)	1.30 (33.0)	0.94 (24.0)
1/4"	5/8"	3/8"	95 4586 14	1.14 (29.0)	2.38 (60.5)	1.26 (32.0)	0.56 (14.3)	1.54 (39.0)	1.18 (30.0)
3/8"	1/4"	1/4"	95 4586 05	0.69 (17.5)	2.05 (52.0)	0.96 (24.5)	0.56 (14.3)	0.93 (23.5)	0.71 (18.0)
3/8"	1/4"	3/8"	95 4586 27	0.82 (20.8)	2.24 (57.0)	1.10 (28.0)	0.56 (14.3)	0.93 (23.5)	0.87 (22.0)
3/8"	3/8"	1/4"	95 4586 03	0.69 (17.5)	2.05 (52.0)	0.96 (24.5)	0.56 (14.3)	1.08 (27.5)	0.71 (18.0)
3/8"	3/8"	3/8"	95 4586 10	0.82 (20.8)	2.24 (57.0)	1.10 (28.0)	0.56 (14.3)	1.14 (29.0)	0.87 (22.0)
3/8"	3/8"	1/2"	95 4586 04	0.91 (23.0)	2.64 (67.0)	1.42 (36.0)	0.75 (19.1)	1.22 (31.0)	0.94 (24.0)
3/8"	1/2"	3/8"	95 4586 26	0.87 (22.0)	2.36 (60.0)	1.14 (29.0)	0.56 (14.3)	1.30 (33.0)	0.87 (22.0)
1/2"	1/4"	1/2"	95 4586 02	0.91 (23.0)	2.64 (67.0)	1.42 (36.0)	0.75 (19.1)	1.04 (26.5)	0.94 (24.0)
1/2"	3/8"	3/8"	95 4586 20	0.87 (22.0)	2.44 (62.0)	1.14 (29.0)	0.56 (14.3)	1.22 (31.0)	0.87 (22.0)
1/2"	1/2"	1/4"	95 4586 16	0.87 (22.0)	2.44 (62.0)	1.14 (29.0)	0.56 (14.3)	1.30 (33.0)	0.87 (22.0)
1/2"	1/2"	3/8"	95 4586 11	0.87 (22.0)	2.44 (62.0)	1.14 (29.0)	0.56 (14.3)	1.30 (33.0)	0.87 (22.0)
1/2"	1/2"	1/2"	95 4586 15	0.91 (23.0)	2.72 (69.0)	1.42 (36.0)	0.75 (19.1)	1.30 (33.0)	0.94 (24.0)

Side Tee Adapters NPT, NPT Female

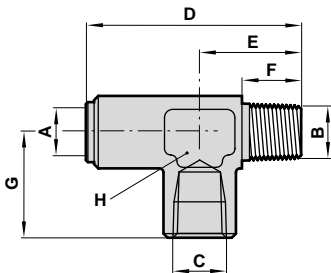

SAE 630835

A Tube O.D.	B NPT	C NPT Female	Product Number	D	E	F	G	H A/F
1/4"	1/4"	1/4"	95 4585 10	1.97 (50.0)	0.96 (24.5)	0.56 (14.3)	0.96 (24.5)	0.71 (18.0)
3/8"	1/4"	1/4"	95 4585 03	2.05 (52.0)	0.96 (24.5)	0.56 (14.3)	0.96 (24.5)	0.71 (18.0)
3/8"	1/4"	1/8"	95 4585 11	2.07 (52.5)	0.96 (24.5)	0.56 (14.3)	0.79 (20.0)	0.71 (18.0)
1/2"	3/8"	1/4"	95 4585 05	2.44 (62.0)	1.14 (29.0)	0.56 (14.3)	0.98 (25.0)	0.87 (22.0)
1/2"	1/2"	1/8"	95 4585 02	2.40 (61.0)	1.08 (27.5)	0.75 (19.1)	-	0.94 (24.0)
1/2"	1/2"	1/4"	95 4585 04	2.72 (69.0)	1.42 (36.0)	0.75 (19.1)	0.98 (25.0)	0.94 (24.0)



Side Tee Adapters NPT, NPT Female

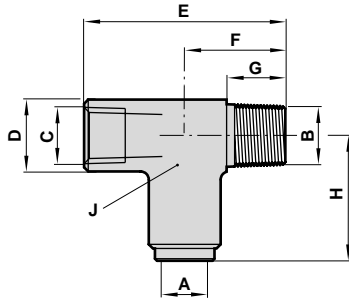

A Tube O.D.	B NPT	C NPT Female	Product Number	D	E	F	G	H	J A/F
3/8"	1/4"	1/4"	95 4587 01	0.34 (8.7)	1.93 (49.0)	0.96 (24.5)	0.56 (14.3)	1.08 (27.5)	0.71 (18.0)

Male Swivel Run Tees NPT

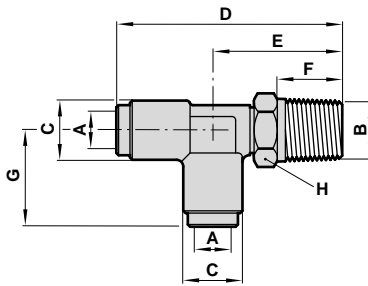

SAE 6308AB

A Tube O.D.	B NPT	Product Number	ØC	D	E	F	G	H A/F
1/4"	1/8"	95 4112 04	0.51 (13.0)	1.75 (44.4)	0.91 (23.2)	0.37 (9.5)	0.83 (21.2)	0.43 (11.0)
1/4"	1/4"	95 4112 10	0.51 (13.0)	1.95 (49.6)	1.12 (28.4)	0.56 (14.3)	0.83 (21.2)	0.55 (14.0)
3/8"	1/4"	95 4112 12	0.67 (17.0)	2.36 (60.0)	1.29 (32.7)	0.56 (14.3)	1.07 (27.3)	0.75 (19.0)
3/8"	3/8"	95 4112 20	0.67 (17.0)	2.32 (58.9)	1.24 (31.6)	0.56 (14.3)	1.07 (27.3)	0.75 (19.0)
3/8"	1/2"	95 4112 29	0.67 (17.0)	2.50 (64.1)	1.44 (36.8)	0.75 (19.1)	1.07 (27.3)	0.87 (22.0)
1/2"	1/4"	95 4112 13	0.81 (20.6)	2.15 (54.5)	1.27 (32.2)	0.56 (14.3)	1.27 (32.3)	0.87 (22.0)
1/2"	3/8"	95 4112 21	0.81 (20.6)	2.69 (68.4)	1.42 (36.1)	0.56 (14.3)	1.27 (32.3)	0.87 (22.0)
1/2"	1/2"	95 4112 30	0.81 (20.6)	2.89 (73.4)	1.62 (41.1)	0.75 (19.1)	1.27 (32.3)	0.87 (22.0)

Note: The Swivel feature should be used for positioning purposes only and should not be used as a rotating joint.

Special Tee Adaptors NPT Female, NPT

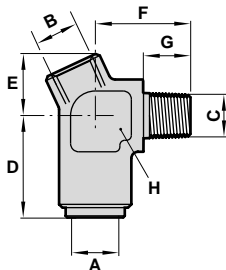

A Tube O.D.	B NPT Female	C NPT	Product Number	D	E	F	G	H A/F
1/2"	1/4"	1/4"	95 4563 01	1.22 (31.0)	0.75 (19.0)	1.14 (29.0)	0.56 (14.3)	0.87 (22.0)
1/2"	1/4"	3/8"	95 4563 02	1.30 (33.0)	0.75 (19.0)	1.14 (29.0)	0.56 (14.3)	0.87 (22.0)

Special Hobbs Side Tee Adaptors Metric, NPT Female

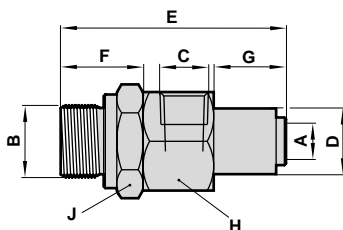

A Tube O.D.	B Thread	C NPT Female	Product Number	ØD	E	F	G	H A/F	J A/F
3/8"	M22 x 1.5	1/4"	95 4423 01	0.79 (20.0)	2.74 (69.5)	0.98 (25.0)	0.87 (22.0)	1.18 (30.0)	1.18 (30.0)



FleetFit Vehicle Push-In Fittings

Dimensions in Inches (mm)

Special 90° Bulkhead Tees NPT

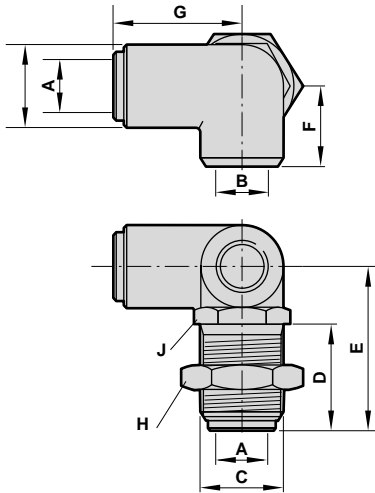

A Tube O.D.	B NPT	C NPT	Product Number	ØD	E	F	G	H A/F	J A/F
1/4"	1/4"	5/8"	95 4679 01	0.85 (21.5)	1.63 (41.5)	0.71 (18.0)	1.04 (26.5)	15/16"	0.87 (22.0)

Special 90° Tees NPT

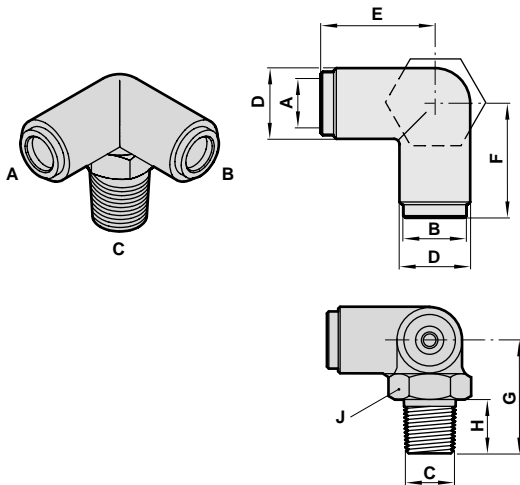

A Tube O.D.	B Tube O.D.	C NPT	Product Number	ØD	E	F	G	H	J A/F
1/4"	1/4"	1/4"	95 4589 01	0.55 (14.0)	0.93 (23.5)	0.93 (23.5)	1.07 (27.3)	0.56 (14.3)	0.55 (14.0)
1/4"	3/8"	3/8"	95 4589 11	0.85 (21.6)	1.04 (26.5)	1.14 (29.0)	1.34 (34.0)	0.56 (14.3)	0.87 (22.0)
3/8"	3/8"	3/8"	95 4589 19	0.85 (21.6)	1.18 (30.0)	1.30 (33.0)	1.34 (34.0)	0.56 (14.3)	0.87 (22.0)
3/8"	3/8"	1/4"	95 4589 16	0.85 (21.6)	1.14 (29.0)	1.14 (29.0)	1.34 (34.0)	0.56 (14.3)	0.87 (22.0)
3/8"	1/2"	3/8"	95 4589 10	0.85 (21.6)	1.18 (30.0)	1.30 (33.0)	1.34 (34.0)	0.56 (14.3)	0.87 (22.0)
3/8"	1/2"	1/2"	95 4589 07	0.85 (21.6)	1.18 (30.0)	1.30 (33.0)	1.54 (39.0)	0.75 (19.1)	0.87 (22.0)
1/2"	1/2"	3/8"	95 4589 04	0.85 (21.6)	1.30 (33.0)	1.30 (33.0)	1.34 (34.0)	0.56 (14.3)	0.87 (22.0)
1/2"	1/2"	1/2"	95 4589 02	0.85 (21.6)	1.30 (33.0)	1.30 (33.0)	1.54 (39.0)	0.75 (19.1)	0.87 (22.0)
1/2"	5/8"	1/2"	95 4589 05	1.15 (29.2)	1.46 (37.0)	1.63 (41.5)	1.69 (43.0)	0.75 (19.1)	0.87 (22.0)
5/8"	5/8"	1/2"	95 4589 06	1.15 (29.2)	1.63 (41.5)	1.63 (41.5)	1.69 (43.0)	0.75 (19.1)	0.87 (22.0)

90° Fixed Tee with side tapped port

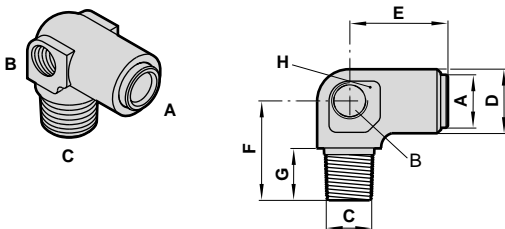

A Tube O.D.	B NPT Female	C NPT	Product Number	ØD	E	F	G	H A/F
1/2"	1/4"	1/2"	95 4584 02	0.94 (24.0)	1.28 (32.5)	1.38 (35.0)	0.75 (19.1)	0.94 (24.0)



90° Fixed Tee

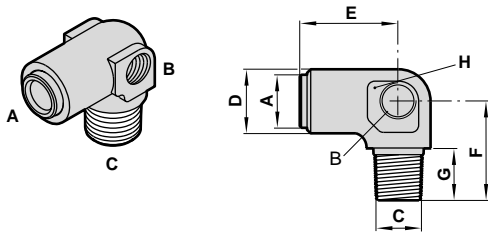

Note: Ports are threaded on side shown.

A O/D Tube	B NPT Female	C NPT	Product Number	ØD	E	F	G	H A/F
3/8"	1/8"	3/8"	95 4565 03	0.83 (21.0)	1.12 (28.5)	1.10 (28.0)	0.56 (14.3)	0.87 (22.0)
3/8"	1/8"	1/4"	95 4565 04	0.83 (21.0)	1.20 (30.5)	1.10 (28.0)	0.56 (14.3)	0.87 (22.0)
1/2"	1/8"	3/8"	95 4565 01	0.87 (22.0)	1.26 (32.0)	1.14 (29.0)	0.56 (14.3)	0.87 (22.0)
1/2"	1/4"	1/2"	95 4565 02	0.94 (24.0)	1.28 (32.5)	1.38 (35.0)	0.75 (19.1)	0.94 (24.0)
3/4"	1/4"	1/2"	95 4565 05	—	1.52 (38.5)	1.48 (37.5)	0.75 (19.1)	0.94 (24.0)

45° Tee Adapter

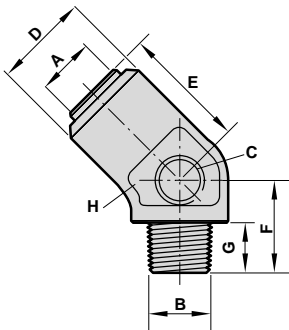

Note: Ports are threaded on opposite side shown.

A O/D Tube	B NPT	C NPT	Product Number	ØD	E	F	G	H A/F
1/2"	3/8"	1/4"	95 4653 02	1.06 (27.0)	1.38 (35.0)	1.02 (26.0)	0.56 (14.3)	1.06 (27.0)
5/8"	3/8"	1/8"	95 4653 03	1.06 (27.0)	1.46 (37.0)	1.02 (26.0)	0.56 (14.3)	1.06 (27.0)

45° Tee Adapter

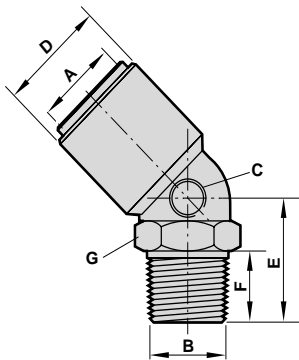

Note: Ports are threaded on side shown.

A O/D Tube	B NPT	C NPT	Product Number	ØD	E	F	G A/F
1/2"	3/8"	1/4"	95 4656 02	1.06 (27.0)	1.02 (26.0)	0.56 (14.3)	1.06 (27.0)
3/4"	1/2"	1/8"	95 4656 01	1.18 (30.0)	1.30 (33.0)	0.75 (19.1)	1.00 (25.4)

Special Bracketed Tee Adaptors NPT Female

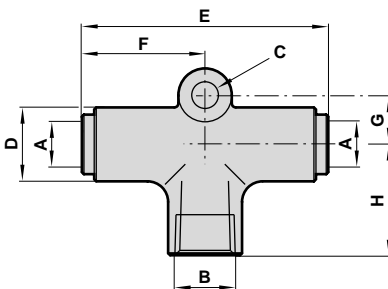

A O/D Tube	B NPT Female	C ØC	Product Number	ØD	E	F	G	H
3/8"	1/4"	0.26 (6.5)	95 4622 02	0.75 (19.0)	2.34 (59.4)	1.17 (29.7)	0.47 (12.0)	1.06 (27.0)



FleetFit Vehicle Push-In Fittings

Dimensions in Inches (mm)

Special 4-Way Adaptors NPT Female

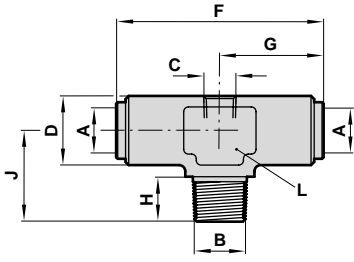

A O/D Tube	B NPT	C NPT Female	Product Number	D	E	F	G	H	J	K	L A/F
1/4"	1/4"	1/4"	95 4594 03*	0.69 (17.5)	0.69 (17.5)	1.93 (49.0)	0.96 (24.5)	0.49 (12.5)	0.87 (22.0)	1.73 (44.0)	- -
1/2"	3/8"	1/8"	95 4594 04	0.87 (22.0)	-	2.60 (66.0)	1.30 (33.0)	0.56 (14.3)	1.14 (29.0)	-	0.08 (2.0)
1/2"	1/2"	1/8"	95 4594 02	1.14 (29.0)	-	2.76 (70.0)	1.38 (35.0)	0.75 (19.1)	1.56 (39.5)	-	1.18 (30.0)
1/2"	1/2"	1/4"	95 4594 01	1.14 (29.0)	-	2.76 (70.0)	1.38 (35.0)	0.75 (19.1)	1.56 (39.5)	-	1.18 (30.0)

* Special SAE short thread

Union Tee

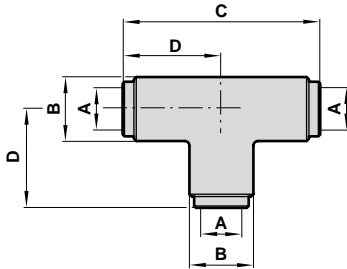

SAE 630401

A O/D Tube	Product Number	ØB	C	D
1/4"	94 4514 04	0.51 (13.0)	1.65 (42.0)	0.83 (21.0)
3/8"	94 4514 06	0.67 (17.0)	2.13 (54.2)	1.07 (27.1)
1/2"	94 4514 07	0.81 (20.5)	2.53 (64.2)	1.26 (32.1)
5/8"	94 4514 08	1.06 (27.0)	3.07 (78.0)	1.54 (39.0)

Reducing Tee Connectors

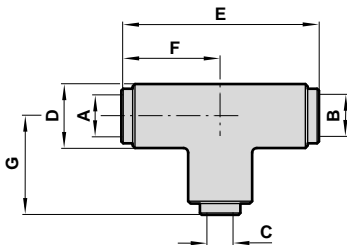

SAE 630401

A O/D Tube	B O/D Tube	C O/D Tube	Product Number	ØD	E	F	G
1/4"	1/4"	3/8"	94 4588 17	0.68 (17.2)	1.85 (47.0)	0.93 (23.5)	1.08 (27.5)
3/8"	1/4"	1/4"	94 4588 16	0.68 (17.2)	2.01 (51.0)	1.08 (27.5)	0.93 (23.5)
3/8"	3/8"	1/4"	94 4588 01	0.68 (17.2)	2.17 (55.0)	1.08 (27.5)	0.93 (23.5)
3/8"	3/8"	1/2"	94 4588 02	0.81 (20.6)	2.36 (60.0)	1.18 (30.0)	1.28 (32.5)
1/2"	3/8"	3/8"	94 4588 04	0.81 (20.6)	2.46 (62.5)	1.28 (32.5)	1.18 (30.0)
1/2"	1/2"	1/4"	94 4588 10	0.81 (20.6)	2.52 (64.0)	1.26 (32.0)	0.98 (25.0)
1/2"	1/2"	3/8"	94 4588 11	0.81 (20.6)	2.44 (62.0)	1.22 (31.0)	1.22 (31.0)
5/8"	1/2"	5/8"	94 4588 14	1.06 (27.0)	3.01 (76.5)	1.56 (39.5)	1.56 (39.5)



Special Bracketed Reducing Tee Connectors

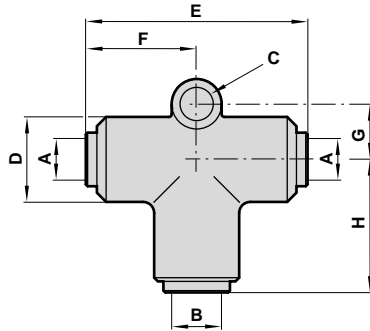

A O/D Tube	B O/D Tube	ØC	Product Number	ØD	E	F	G	H
3/8"	1/2"	0.35 (9.0)	94 4688 02	0.91 (23.0)	2.36 (60.0)	1.18 (30.0)	0.59 (15.0)	1.42 (36.0)

Special Bulkhead Tees UNF / SAE 45° flare

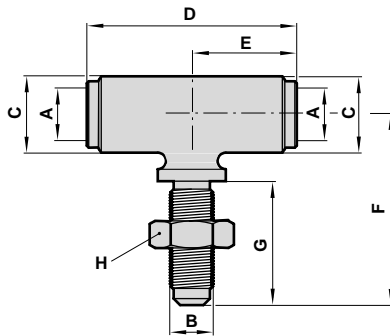

A O/D Tube	B UNF	Product Number	ØC	D	E	F	G	H A/F
3/8"	5/8"	94 4598 04	0.87 (22.0)	2.13 (54.0)	1.06 (27.0)	2.44 (62.0)	1.69 (43.0)	1-5/16"
3/8"	3/4"	94 4598 01	0.87 (22.0)	2.20 (56.0)	1.10 (28.0)	2.56 (65.0)	1.81 (46.0)	1-1/8"
1/2"	5/8"	94 4598 05	0.87 (22.0)	2.52 (64.0)	1.26 (32.0)	2.56 (65.0)	1.81 (46.0)	1-5/16"

6 Port Manifold*

A O/D Tube	B O/D Tube	Product Number	C	D	E	F	G	H	J	K	L
1/4"	3/8"	94 8125 00	0.22 (5.7)	2.76 (70.0)	0.63 (16.0)	0.62 (15.8)	4.10 (103.0)	0.87 (22.0)	0.75 (19.0)	0.47 (12.0)	1.33 (33.8)

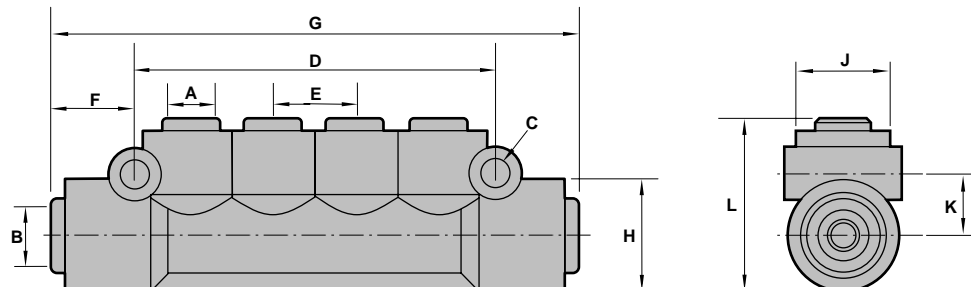

* Materials of construction: Thermoplastic body, with brass inserts and collets.