

Filter-Lubricators

Combination units from 1/8" to 1-1/2".

07 Series Filter-Lubricator 1/8" and 1/4" Port Sizes	ALE-23-2
Excelon 72 Filter-Lubricator Combination Units 1/4" and 3/8" Port Sizes	ALE-23-4
Excelon 73 Filter-Lubricator Combination Units 1/4", 3/8", 1/2" Port Sizes	ALE-23-8
Excelon 74 Filter-Lubricator Combination Units 3/8", 1/2", 3/4" Port Sizes	ALE-23-12
17 Series Filter-Lubricator Combination Units 3/4", 1", 1-1/4", 1-1/2" Port Sizes.....	ALE-23-16
Olympian 64 Filter-Lubricator Combination Units 1/4", 3/8", 1/2", and 3/4" Port Sizes....	ALE-23-18



07 Series



72 Series



73 Series



74 Series



64 Series



17 Series

P1C, PTC Combination Unit

07 Series Filter-Lubricator
1/8" and 1/4" Port Sizes

- Compact design
- Filter removes liquids and solid particles down to 5 µm
- Micro-Fog lubricator provides air line lubrication to one or more air driven tools or other devices
- Nearly constant oil density output with varying air flow
- Can be disassembled without the use of tools or removal from the air line



Ordering information. Models listed include PTF threads, filter with transparent bowl, automatic drain, 5 µm element, lubricator with transparent reservoir and manual drain.

Port Size	Model Numbers	Weight lb (kg)
1/8"	P1C-100-A1AA	0.58 (0.26)
1/4"	P1C-200-A1AA	0.58 (0.26)

Alternative Models

Port Size		Substitute		Threads		Substitute	
1/8"	1	1	1	PTF	A		
1/4"	2	2	2	ISO Rc taper	B		
				ISO G parallel	G		
Filter Bowl		Substitute		Lubricator Reservoir		Substitute	
Transparent	00	00	00	Transparent with drain	A		
Metal	40	40	40	Transparent without drain	Q		
				Metal with drain / no sight glass	M		
				Metal without drain / no sight glass	F		
Filter Element		Substitute		Filter Drain		Substitute	
5 µm	1	1	1	Automatic	A		
40 µm	3	3	3	Manual	M		

ISO Symbols

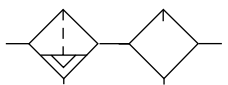

Filter with automatic drain,
lubricator with manual drain

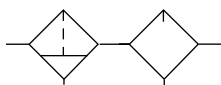

Filter manual drain, lubricator
with manual drain

See Section ALE-25 for Accessories



Technical Data

Fluid: Compressed air

Maximum pressure:

Transparent bowl: 150 psig (10 bar)

Metal bowl: 250 psig (17 bar)

Operating temperature *

Transparent bowl: 0° to 125°F (-20° to 50°C)

Metal bowl: 0° to 175°F (-20° to 80°C)

* Air supply must be dry enough to avoid ice formation at temperatures below 35°F (2°C).

Nominal bowl size: 1 fluid ounce (31 ml)

Drain connection: Will fit 1/8-27 and 1/8-28 pipe thread

Filter

Automatic drain operation: Spitter type drain operates momentarily when a rapid change in air flow occurs or when the supply pressure is reduced.

Lubricator

Start point (i.e. minimum flow required for lubricator operation): 0.5 scfm (0.24 dm³/s) at 90 psig (6.3 bar) inlet pressure

Nominal bowl size: 1 fluid ounce (31 ml)

Recommended lubricants: See Section ALE-29.

Materials:

Body: Zinc

Bowl

Transparent: Polycarbonate

Metal: Zinc

Filter element: Sintered polypropylene

Sight feed dome: Transparent nylon

Elastomers: Neoprene and nitrile

Service Kits

Item	Type	Part number
Service kits, filter	5 µm element	3652-17
	40 µm element	3852-18
Service kit, lubricator		3795-03
Replacement drains	Manual	773-03
	Automatic	3654-02

Filter service kit contains element, element gasket, and bowl o-ring. Lubricator service kit contains sight-feed dome seal, cartridge o-ring, and bowl o-ring.

All Dimensions in Inches (mm)

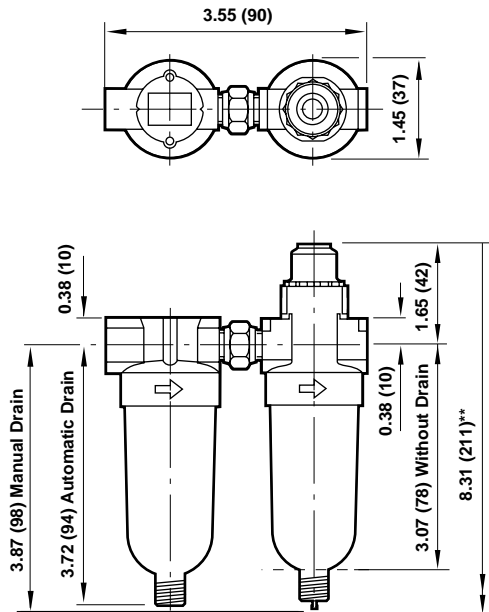

** Minimum clearance to remove bowl

- True modularity with Norgren Quikclamp™ connections
- Quick release bayonet bowl
- Flow sensor design provides a nearly constant oil/air ratio over a wide range of air flows
- Highly visible, prismatic liquid level indicator lens
- All around (360°) visibility of the sight-feed dome simplifies installation and adjustment

Use Micro-Fog models in applications containing one or more points of lubrication.

Use Oil-Fog models to lubricate a single tool, cylinder, or other air driven device.



Technical Data

Fluid: Compressed air

Maximum pressure:

Transparent bowl: 150 psig (10 bar)

Metal bowl:

Manual or semi automatic drain: 250 psig (17 bar)

Automatic drain: 150 psig (10 bar)

Operating temperature*:

Transparent bowl: 0° to 125°F (-20° to 50°C)

Metal bowl: 0° to 150°F (-20° to 65°C)

* Air supply must be dry enough to avoid ice formation at temperatures below 35°F (2°C).

Particle removal: 5 µm, 25 µm, or 40 µm filter element

Manual drain connection: Will fit 1/8-27 and 1/8-28 pipe thread

Semi automatic drain connection: Push on 5/16" (8 mm) ID tube

Semi automatic drain operating conditions (pressure operated)

Bowl pressure required to close drain: Greater than 1.5 psig (0.1 bar)

Bowl pressure required to open drain: Less than 1.5 psig (0.1 bar)

Minimum air flow required to close drain: 1 scfm (0.5 dm³/s)

Manual operation: Lift stem to drain bowl

Automatic drain connection: Will fit 1/8-27 and 1/8-28 pipe thread

Automatic drain operating conditions (float operated)

Bowl pressure required to close drain: Greater than 5 psig (0.3 bar)

Bowl pressure required to open drain: Less than 3 psig (0.2 bar)

Minimum air flow required to close drain: 0.2 scfm (0.1 dm³/s)

Manual operation: Depress pin inside drain outlet to drain bowl

Nominal bowl size

Short bowl: 1.9 fluid ounce (56 ml)

Long bowl: 2.2 fluid ounce (65 ml)

Recommended lubricants: See Section ALE-29.

Materials

Body: Zinc

Bowl

Transparent: Polycarbonate

Transparent with guard: Polycarbonate, Zinc guard

Metal: Zinc

Metal bowl liquid level indicator lens: Transparent nylon

Element: Sintered polypropylene

Sight-Feed dome: Transparent nylon

Elastomers: Neoprene, nitrile

ISO Symbols

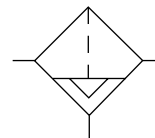

Filter with Automatic Drain

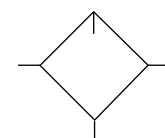

Lubricator with Drain

See Section ALE-25 for Accessories



Ordering information. Models listed include PTF threads. Filter (F) has automatic drain, long transparent bowl without guard, and a 40 µm element. Lubricator (L) is a Micro-Fog model with 1/4 turn manual drain and long transparent bowl with guard.

Combination Unit Type	Port Size	Model	Weight lb (kg)
Filter-Lubricator (F-L)	1/4"	C72C-2AN-AL3-NNN-QLN	2.3 (1.04)
	3/8"	C72C-3AN-AL3-NNN-QLN	2.3 (1.04)

Alternative Models

★ 7 2 ★ - ★ ★ ★ - ★ ★ ★ - ★ ★ ★ - ★ ★ ★

Shutoff/Lockout Valve, Quikmount Standard Combination (No Shutoff/Lockout Valve, no Quikmount)	Substitute
	C
With Shutoff/Lockout valve on inlet	D
With Quikmount pipe adapters on inlet and outlet	E
With Shutoff/Lockout Valve on inlet and Quikmount pipe adapter on outlet	G

Combination Unit Type	Substitute
Micro-Fog F-L	C
Oil-Fog F-L	D

Port Size	Substitute
1/4"	2
3/8"	3

Threads	Substitute
PTF	A
ISO Rc taper	B
ISO G parallel	G

Regulator Option	Substitute
Non Applicable	N

Filter Drain	Substitute
Automatic †	A
Manual, 1/4 turn	Q
Semi automatic	S

Filter Bowl	Substitute
Short metal with liquid level indicator	D
Long metal with liquid level indicator	E
Short transparent without guard	T
Long transparent without guard	L

† Available only with long bowl. Long transparent with

Accessories	Substitute
Quikclamp wall brackets	B
No accessories	N

Lubricator Bowl	Substitute
Short metal with liquid level indicator	D
Long metal with liquid level indicator	E
Short transparent without guard	T
Long transparent without guard	L
Long transparent with guard	W

Lubricator Drain	Substitute
Closed bottom	E
Manual, 1/4 turn	Q

Regulator Option	Substitute
Non Applicable	N

Regulator Option	Substitute
Non Applicable	N

Regulator Option	Substitute
Non Applicable	N

Filter Element	Substitute
5 µm	1
25 µm	2
40 µm	3



F72-L72 Combination Unit

All Dimensions in Inches (mm)

Standard Micro-Fog Type C72C- Standard Oil-Fog Type C72D-

Shown with optional Quikclamp wall bracket.

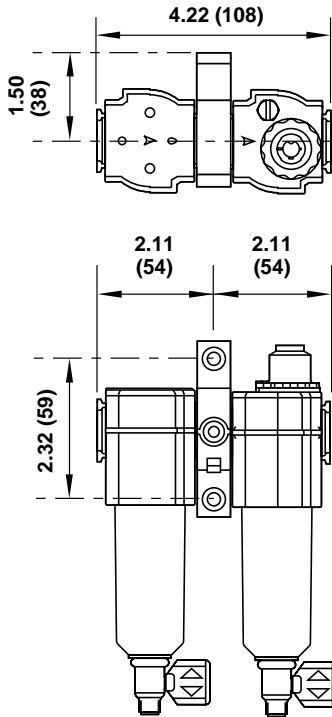

Alternative Micro-Fog Type D72C- Alternative Oil-Fog Type D72D-

Includes Shutoff/Lockout valve.

Shown with optional Quikclamp wall brackets.

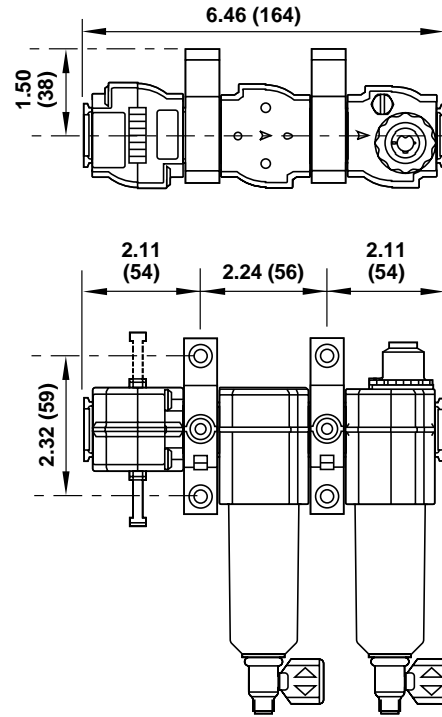

F72-L72 Combination Unit

All Dimensions in Inches (mm)



**Alternative Micro-Fog Type E72C-
Alternative Oil-Fog Type E72D-
Includes Quikmount pipe adapters.**

Shown with optional Quikclamp wall brackets.

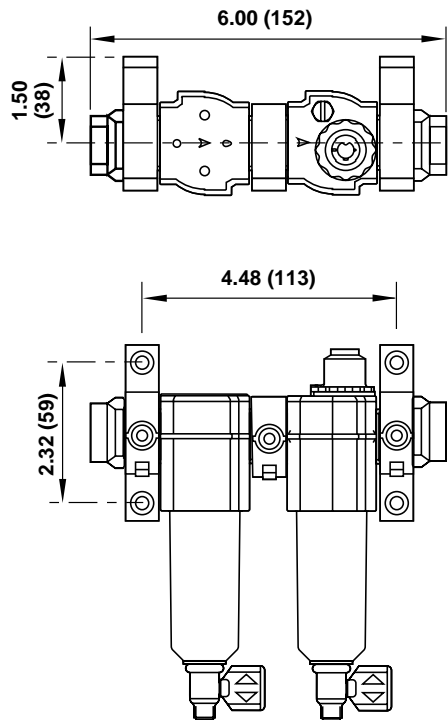

**Alternative Micro-Fog Type G72C-
Alternative Oil-Fog Type G72D-
Includes Shutoff/Lockout valve and Quikmount pipe adapter.**

Shown with optional Quikclamp wall brackets.

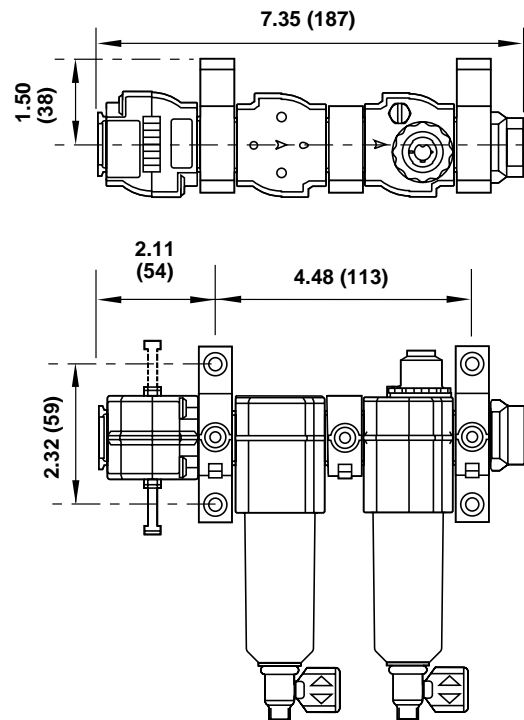

- True modularity with Norgren Quikclamp™ connections
- Quick release bayonet bowl
- Flow sensor design provides a nearly constant oil/air ratio over a wide range of air flows
- Highly visible, prismatic liquid level indicator lens
- All around (360°) visibility of the sight-feed dome simplifies installation and adjustment

Use Micro-Fog models in applications containing one or more points of lubrication.

Use Oil-Fog models to lubricate a single tool, cylinder, or other air driven device.



Technical Data

Fluid: Compressed air

Maximum pressure

Transparent bowl: 150 psig (10 bar)

Metal bowl: 250 psig (17 bar)

Operating temperature*

Transparent bowl: 0° to 125°F (-20° to 50°C)

Metal bowl: 0° to 175°F (-20° to 80°C)

* Air supply must be dry enough to avoid ice formation at temperatures below 35°F (2°C).

Particle removal: 5 µm, 25 µm, or 40 µm filter element

Manual drain connection: Will fit 1/8-27 and 1/8-28 pipe threads

Automatic drain connection: Will fit 1/8-27 and 1/8-28 pipe threads

Automatic drain operating conditions (float operated):

Bowl pressure required to close drain: Greater than 5 psig (0.3 bar)

Bowl pressure required to open drain: Less than 3 psig (0.2 bar)

Minimum air flow required to close drain: 0.2 scfm (0.1 dm³/s)

Manual operation: Depress pin inside drain outlet to drain bowl

Nominal bowl size: 3.5 fluid ounce (0.1 liter)

Recommended lubricants: See Section ALE-29.

Materials

Body: Aluminum

Bowl

Transparent: Polycarbonate

Transparent with guard: Polycarbonate, steel guard

Metal: Aluminum

Metal bowl liquid level indicator lens: Transparent nylon

Element: Sintered polypropylene

Sight-Feed dome: Transparent nylon

Elastomers: Neoprene and nitrile

ISO Symbols

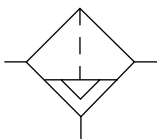

Filter with Automatic Drain

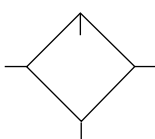

Lubricator with Drain

See Section ALE-25 for Accessories



Ordering information

Models listed in order table have PTF threads. Filter (F) has automatic drain, metal bowl with liquid level indicator, and a 40 µm element. Lubricator (L) is a Micro-Fog model with 1/4 turn manual drain and metal bowl with liquid level indicator.

Combination Unit Type	Port Size	Model	Weight lb (kg)
Filter-Lubricator (F-L)	1/4"	C73C-2AN-AD3-NNN-QDN	2.6 (1.18)
	3/8"	C73C-3AN-AD3-NNN-QDN	2.6 (1.18)
	1/2"	C73C-4AN-AD3-NNN-QDN	2.6 (1.18)

Alternative Models

★ 7 3 ★ - ★ ★ ★ - ★ ★ ★ - ★ ★ ★ - ★ ★ ★

Lockout Valve/ Quikmount	Substitute	Accessories	Substitute
Standard Combination (No Lockout Valve, no Quikmount)	C	Accessories B and D	A
With Lockout valve on inlet	D	Quikclamp wall brackets	B
With Quikmount pipe adapters on inlet and outlet	E	Accessories B and Q	C
With Lockout valve on inlet and Quikmount pipe adapter on outlet	G	Filter service indicator	D
		Accessories B , D , and Q	H
		No accessories	N
		Lubricator quick fill nipple	Q
Combination Unit Type	Substitute	Lubricator Bowl	Substitute
Micro-Fog F-L	C	Metal with liquid level indicator	D
Oil-Fog F-L	D	Transparent with guard	P
		Transparent	T
Port Size	Substitute	Lubricator Drain	Substitute
1/4"	2	Closed bottom	E
3/8"	3	Manual, 1/4 turn	Q
1/2"	4		
Threads	Substitute	Regulator Option	Substitute
PTF	A	Non Applicable	N
ISO Rc taper	B		
ISO G parallel	G	Regulator Option	Substitute
		Non Applicable	N
Regulator Option	Substitute	Regulator Option	Substitute
Non Applicable	N	Non Applicable	N
Filter Drain	Substitute	Filter Element	Substitute
Automatic	A	5 µm	1
Manual, 1/4 turn	Q	25 µm	2
		40 µm	3
Filter Bowl	Substitute		
Metal with liquid level indicator	D		
Transparent with zinc guard	P		
Transparent	T		



F73-L73 Combination Unit

All Dimensions in Inches (mm)

**Standard Micro-Fog Type C73C-
Standard Oil-Fog Type C73D-**

Shown with optional Quikclamp wall bracket.

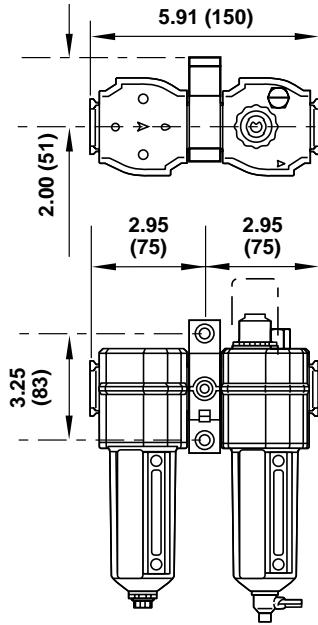

**Alternative Micro-Fog Type D73C-
Alternative Oil-Fog Type D73D-**

Includes lockout valve.

Shown with optional Quikclamp wall bracket.

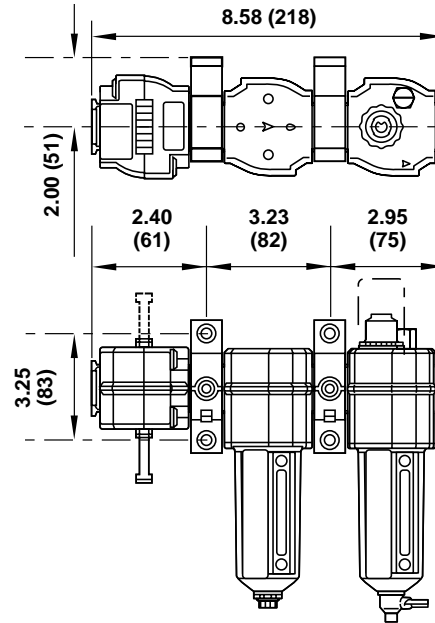

F73-L73 Combination Unit

All Dimensions in Inches (mm)



**Alternative Micro-Fog Type E73C-
Alternative Oil-Fog Type E73D-**

Includes Quikmount pipe adapters.

Shown with optional Quikclamp wall bracket.

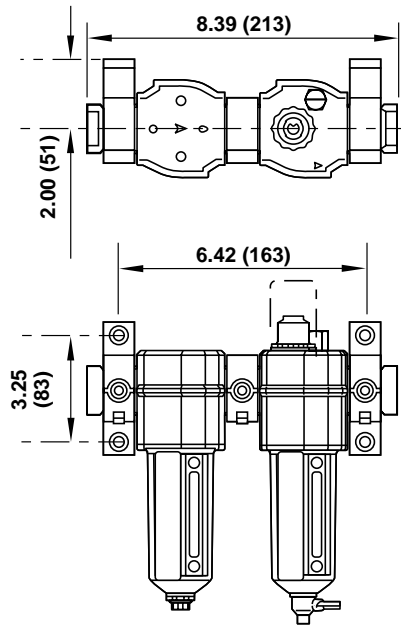

**Alternative Micro-Fog Type G73C-
Alternative Oil-Fog Type G73D-**

**Includes lockout valve and Quikmount
pipe adapter.**

Shown with optional Quikclamp wall bracket.

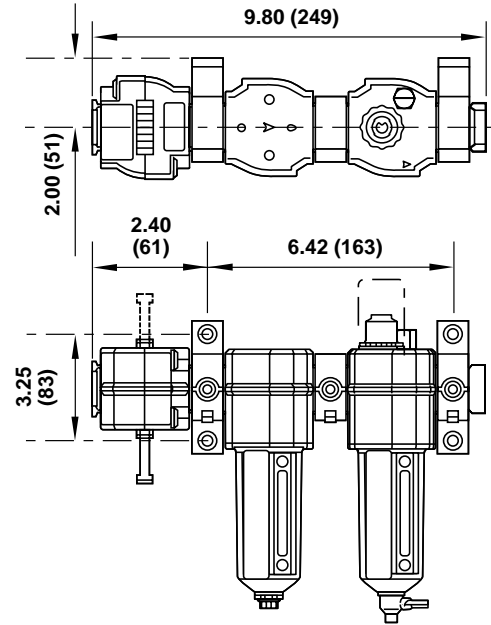

- True modularity with Norgren Quikclamp™ connections
- Quick release bayonet bowl
- Flow sensor design provides a nearly constant oil/air ratio over a wide range of air flows
- Highly visible, prismatic liquid level indicator lens
- All around (360°) visibility of the sight-feed dome simplifies installation and adjustment

Use Micro-Fog models in applications containing one or more points of lubrication.

Use Oil-Fog models to lubricate a single tool, cylinder, or other air driven device.



Technical Data

Fluid: Compressed air

Maximum pressure:

Transparent bowl: 150 psig (10 bar)

Metal bowl: 250 psig (17 bar)

Operating temperature*:

Transparent bowl: 0° to 125°F (-20° to 50°C)

Metal bowl: 0° to 175°F (-20° to 80°C)

* Air supply must be dry enough to avoid ice formation at temperatures below 35°F (2°C).

Particle removal: 5 µm, 25 µm, or 40 µm filter element

Manual drain connection: Will fit 1/8-27 and 1/8-28 pipe threads

Automatic drain connection: Will fit 1/8-27 and 1/8-28 pipe threads

Automatic drain operating conditions (float operated):

Bowl pressure required to close drain: Greater than 5 psig (0.3 bar)

Bowl pressure required to open drain: Less than 3 psig (0.2 bar)

Minimum air flow required to close drain: 2 scfm (1 dm³/s)

Manual operation: Depress pin inside drain outlet to drain bowl

Nominal bowl size:

Standard: 7 fluid ounce (0.2 liter)

Optional size for lubricator: 1 quart US (1 liter)

Recommended lubricants: See Section ALE-29.

Materials

Body: Aluminum

Bowl

Transparent: Polycarbonate with steel bowl guard

Metal: Aluminum

Metal bowl liquid level indicator lens

7 fluid ounce (0.2 liter): Transparent nylon

1 quart US (1 liter): Pyrex

Sight-Feed dome: Transparent nylon

Elastomers: Neoprene and Nitrile

Element: Sintered polypropylene

Elastomers: Neoprene and Nitrile

ISO Symbols

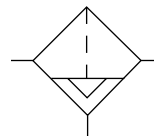

Filter with Automatic Drain

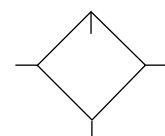

Lubricator with Drain

See Section ALE-25 for Accessories



Ordering information. Models listed include Micro-Fog lubricator, PTF threads, metal filter bowl with liquid level indicator and automatic drain, 40 µm filter element, 7 fluid oz. (0.2 liter) metal lubricator bowl with liquid level indicator and 1/4 turn manual drain.

Combination Unit Type	Port Size	Model	Weight lb (kg)
Filter-Lubricator (F-L)	3/8"	C74C-3AN-AD3-NNN-QDN	3.97 (1.80)
	1/2"	C74C-4AN-AD3-NNN-QDN	3.84 (1.74)
	3/4"	C74C-6AN-AD3-NNN-QDN	3.75 (1.70)

Alternative Models



Lockout Valve/ Quikmount	Substitute
Standard combination (no lockout valve or Quikmount)	C
With lockout valve on inlet	D
With Quikmount pipe adapters on inlet and outlet	E
With lockout valve on inlet and Quikmount pipe adapter on outlet	G

Combination Unit Type	Substitute
Micro-Fog F-L	C
Oil-Fog F-L	D

Port Size	Substitute
3/8"	3
1/2"	4
3/4"	6

Threads	Substitute
PTF	A
ISO Rc taper	B
ISO G parallel	G

Regulator Option	Substitute
Non applicable	N

Filter Drain	Substitute
Automatic	A
Manual, 1/4 turn	Q

Filter Bowl	Substitute
Metal with liquid level indicator	D
Transparent with guard	P

Filter Element	Substitute
5 µm	1
25 µm	2
40 µm	3

Accessories	Substitute
Quikclamp wall brackets and filter service indicator	A
Quikclamp wall brackets	B
Quikclamp wall brackets and lubricator quick fill nipple	C
Filter service indicator	D
Quikclamp wall brackets, filter service indicator and lubricator quick fill nipple	H
No accessories	N
Lubricator quick fill nipple	Q

Lubricator Bowl	Substitute
1 quart US (1 liter) metal with liquid level indicator	A
7 fluid oz. (0.2 liter) metal with liquid level indicator	D
7 fluid oz. (0.2 liter) transparent with zinc guard	P

Lubricator Drain	Substitute
Closed bottom	E
Manual, 1/4 turn	Q
Remote fill *	R

Regulator Option	Substitute
Non applicable	N

Regulator Option	Substitute
Non applicable	N

Regulator Option	Substitute
Non applicable	N

* Use remote fill only with 7 fluid oz. (0.2 liter) bowls.



F74-L74 Combination Unit

All Dimensions in Inches (mm)

**Standard Micro-Fog Type C74C-
Standard Oil-Fog Type C74D-**

Shown with optional Quikclamp wall bracket.

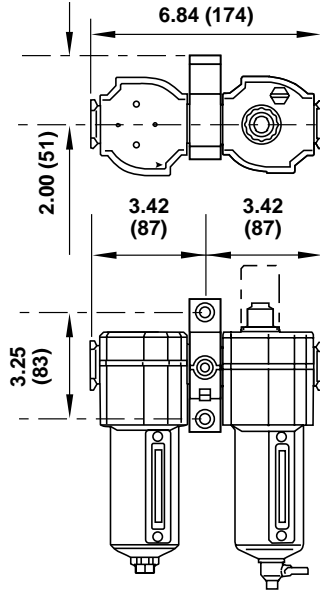

**Alternative Micro-Fog Type D74C-
Alternative Oil-Fog Type D74D-**

Includes Shutoff/Lockout valve.

Shown with optional Quikclamp wall brackets.

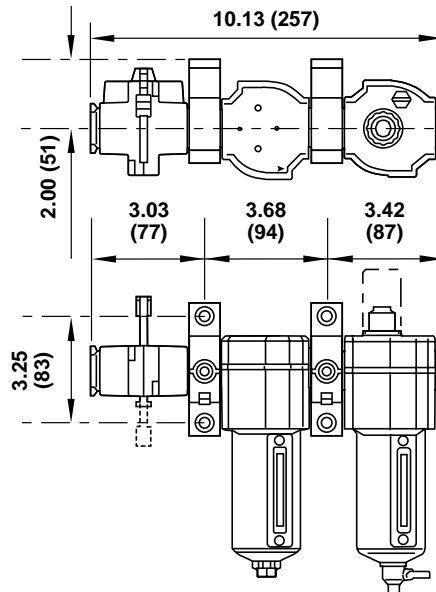

F74-L74 Combination Unit

All Dimensions in Inches (mm)



Alternative Micro-Fog Type E74C- Alternative Oil-Fog Type E74D- Includes Quikmount pipe adapters.

Shown with optional Quikclamp wall brackets.

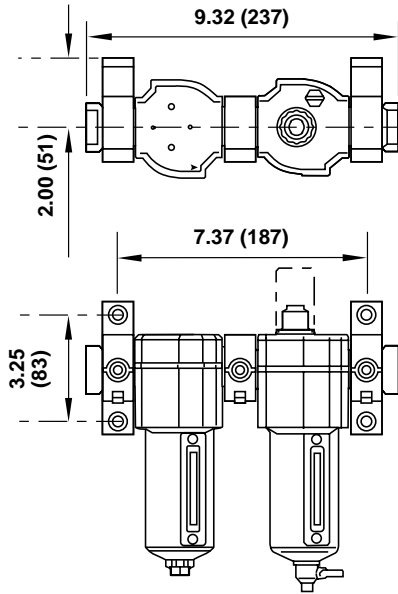

Alternative Micro-Fog Type G74C- Alternative Oil-Fog Type G74D- Includes Shutoff/Lockout valve and Quikmount pipe adapter.

Shown with optional Quikclamp wall brackets.

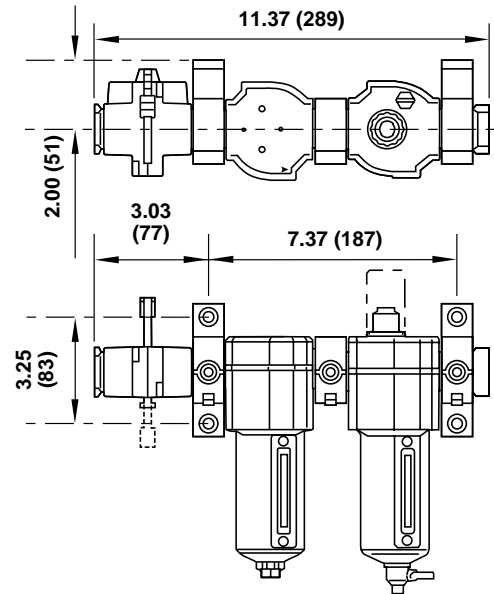

- Combines outstanding features of the Norgren F17 filters and L17 lubricators
- All around (360°) visibility of the lubricator sight-feed dome simplifies installation and adjustment
- Screw-on bowl reduces maintenance time
- Can be disassembled without the use of tools or removal from the air line
- Lubricator flow sensor design provides a nearly constant oil/air ratio over a wide range of air flows



Use Micro-Fog combinations in applications containing one or more points of lubrication

Use Oil-Fog combinations to lubricate a single tool, cylinder, or other air driven device

Ordering Information. Models listed include 1 quart (1 liter) metal bowls with sight glass, automatic drain on filter, manual drain on lubricator, and PTF.

Port Size	Micro-Fog Models	Oil-Fog Models	Weight lbs (kg)
3/4"	P8C-660-A3DA	P8D-660-A3DA	8.49 (3.85)
1"	P8C-860-A3DA	P8D-860-A3DA	8.32 (3.77)
1-1/4"	P8C-A60-A3DA	P8D-A60-A3DA	9.54 (4.33)
1-1/2"	P8C-B60-A3DA	P8D-B60-A3DA	8.36 (3.79)

Alternative Models

P 8 ★ - ★ ★ ★ - ★ ★ ★ ★

Lubricator Type	Substitute
Micro-Fog	C
Oil-Fog	D

Port Size	Substitute
3/4"	6
1"	8
1-1/4"	A
1-1/2"	B

Filter Bowl	Substitute
Metal with sight glass	60

Threads	Substitute
PTF	A
ISO Rc taper	B
BSPP (1-1/2" ported units only)	C
ISO G parallel (not available with 1-1/2" ported units)	G

Lubricator Reservoir	Substitute
1 quart (1 liter) metal, drain, sight glass	D

Filter Element	Substitute
40 µm	3

Filter Drain	Substitute
Automatic	A
Manual	M

ISO Symbols

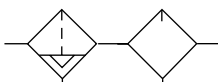

Filter with automatic drain, Lubricator with manual drain

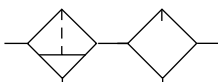

Filter manual drain, Lubricator with manual drain

See Section ALE-25 for Accessories



Technical Data

Fluid: Compressed air
 Maximum pressure: 250 psig (17 bar)
 Operating temperature*: 0° to 175°F (-20° to 80°C)
 * Air supply must be dry enough to avoid ice formation at temperatures below 2°C (35°F).
 Start point (minimum flow required for lubricator operation): 8 scfm (3.8 dm³/s) at 90 psig (6.3 bar) inlet pressure
 Typical flow with 90 psig (6.3 bar) inlet pressure and 7 psig (0.5 bar) pressure drop:
 1" Ports: 250 scfm (118 dm³/s)
 Nominal bowl size: 1 quart US (1 liter)
 Automatic drain connection: Will fit 1/8-27 and 1/8-28 pipe thread
 Automatic drain operating conditions
 Minimum pressure: 10 psig (0.7 bar).
 Drain opens when bowl pressure drops below 3 psig (0.2 bar).
 Minimum air flow: 2 scfm (1 dm³/s) required to close drain.

Recommended lubricants: See Section ALE-29.

Materials

- Body: Aluminum
- Bowls: Aluminum
- Bowl sight glass: Pyrex
- Sight-feed dome: Transparent nylon
- Elastomers: Neoprene and nitrile

Service Kits

Item	Type	Part Number
Lubricator service kit	All o-rings, seals, gaskets	5771-02
Filter service kit	All o-rings, seals, gaskets	5578-05
	40 µm element	5311-03
Replacement drain	Automatic	3000-10
	Manual (1/4 Turn)	619-50
Sight glass kit	All o-rings, seals, gaskets	2273-22

Sight glass kit contains bowl o-ring plus all o-rings, seals, screws, glass, and glass guard.

All Dimensions in Inches (mm)

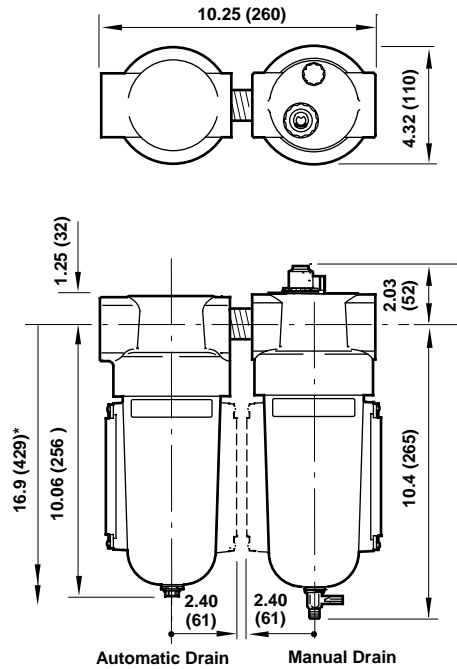

* Minimum clearance required to remove bowl.

FL64 Combination Units

Olympian Plus 64 Filter and Lubricator
1/4", 3/8", 1/2", and 3/4" Port Sizes

- Olympian Plus plug in design
- High Efficiency water and particle removal
- Easy fill lubricator with quick release bayonet bowls
- High visibility prismatic sight glass
- Constant oil density output with varying flow



Technical Data

Fluid: Compressed air

Maximum pressure:

Transparent bowl: 150 psig (10 bar)

Metal bowl: 250 psig (17 bar)

Operating temperature*

Transparent bowl: 0° to 125°F (-20° to 50°C)

Metal bowl: 0° to 175°F (-20° to 80°C)

* Air supply must be dry enough to avoid ice formation at temperatures below 35°F (2°C).

Particle removal: 5 µm, 25 µm, or 40 µm filter element

Manual drain connection: Will fit 1/8-27 and 1/8-28 pipe thread

Automatic drain connection: Will fit 1/8-27 and 1/8-28 pipe thread

Automatic drain operating conditions (float operated):

Bowl pressure required to close drain: Greater than 5 psig (0.3 bar)

Bowl pressure required to open drain: Less than 3 psig (0.2 bar)

Minimum air flow required to close drain: 2 scfm (1 dm³/s)

Manual operation: Depress pin inside drain outlet to drain bowl

Nominal bowl size

Standard: 7 fluid ounce (0.2 liter)

Optional size for lubricator: 1 quart (1 liter)

Recommended lubricants: See Section ALE-29.

Materials

Body and yoke: Zinc

Bowl:

Transparent: Polycarbonate

Metal: Aluminum

Metal bowl liquid level indicator lens:

7 fluid ounce (0.2 liter): Transparent nylon

1 quart (1 liter): Pyrex

Sight-Feed dome: Polycarbonate

Element: Sintered polypropylene

Elastomers: Neoprene and nitrile

Service Kits

Item	Type	Part number
Service kit	Filter	4380-200
Service kit	Lubricator	4382-200
Replacement elements	40 µm	4338-02
	5 µm	4338-01
Replacement sight glass	F64, plastic	4380-040
	L64, plastic	4380-042
	F64, L64, pyrex	4380-041
	L64, 1 quart, pyrex	2273-22
Replacement drains	Automatic	3000-10
	Manual, 1/4 turn	619-50
Service Indicator		5797-50

Filter service kit includes port seals, louver 'O' ring, bowl 'O' ring and drain gasket.

Lubricator service kit includes all seals, flow sensor, eyelet, dome screen, ball and spring.

See Section ALE-25 for Accessories



Ordering information. Models listed include Micro-Fog lubricator, yoke with PTF threads, filter with auto drain, metal bowl with liquid level indicator, 40 µm element; lubricator with 1/4 turn manual drain, 7 fluid ounce (0.2 liter) metal bowl with liquid level indicator.

Combination Unit Type	Port Size	Model	Weight lb (kg)
Filter-Lubricator (F-L)	1/4"	C64C-2AN-AD3-NNN-QDN	10.2 (4.61)
	3/8"	C64C-3AN-AD3-NNN-QDN	9.7 (4.42)
	1/2"	C64C-4AN-AD3-NNN-QDN	9.6 (4.35)
	3/4"	C64C-6AN-AD3-NNN-QDN	8.8 (3.97)

Alternative Models

★ 6 4 ★ - ★ ★ ★ - ★ ★ ★ - ★ ★ ★

Lockout Valve	Substitute
No lockout valve	C
With lockout valve on inlet	D

Combination Unit Type	Substitute
Standard Micro-Fog F-L	C
Standard Oil-Fog F-L	D

Port Size	Substitute
1/4"	2
3/8"	3
1/2"	4
3/4"	6

Threads	Substitute
PTF	A
ISO Rc taper	B
ISO G parallel	G

Regulator Option	Substitute
Not Applicable	N

Filter Drain	Substitute
Automatic	A
Manual, petcock	D
Manual, 1/4 turn	Q

Filter Bowl	Substitute
Metal with liquid level indicator	D
Metal, no liquid level indicator	M
Transparent with guard	P
Metal with pyrex liquid level indicator	R

Filter Element	Substitute
5 µm	1
25 µm	2
40 µm	3
75 µm	4

Accessories	Substitute
B and D	A
Wall brackets	B
B and Q	C
Filter service indicator	D
B and L *	F
B, D, and Q	H
B, D, and L	K
Lubricator low oil level switch *	L
No accessories	N
Lubricator quick fill cap	Q

Lubricator Bowl	Substitute
1 quart (1 liter) metal with pyrex liquid level indicator	A
7 fluid oz. (0.2 liter) metal with plastic liquid level indicator	D
7 fluid oz. (0.2 liter) metal without liquid level indicator	M
7 fluid oz. (0.2 liter) transparent with guard	P
7 fluid oz. (0.2 liter) metal with pyrex liquid level indicator	R

Lubricator Drain	Substitute
Manual, petcock	D
Closed bottom	E
Manual, 1/4 turn	Q
Remote fill **	R

Regulator Option	Substitute
Not Applicable	N

Regulator Option	Substitute
Not Applicable	N

Regulator Option	Substitute
Not Applicable	N

* Lubricator low oil level switch available only with 1 quart (1 liter) bowl.
 ** Lubricator with remote fill available only with 7 fluid oz. (0.2 litre) bowls.



64 Series Filter-Lubricator

All Dimensions in Inches (mm)

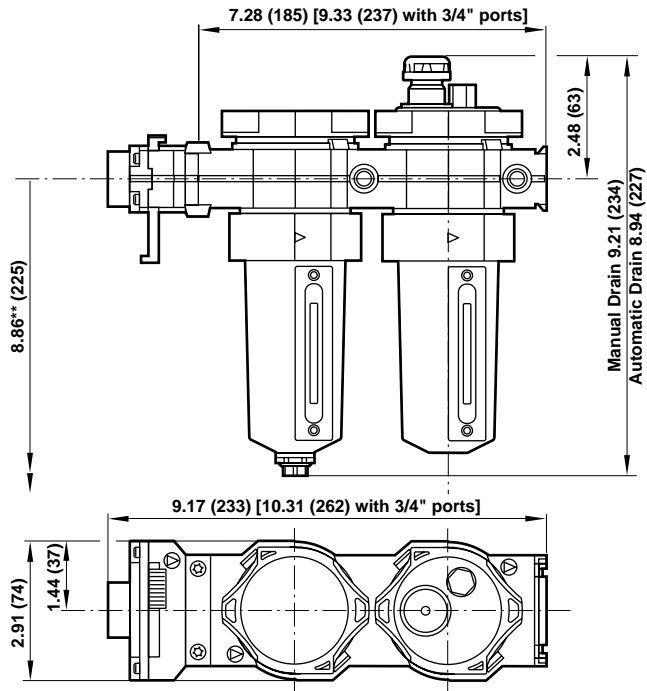

** Minimum clearance required to remove bowl.